

TECHNICAL INFORMATION

CASING

SIZE:	11 3/4 "
NOMINAL WEIGHT:	60.00 lb/ft
WALL THICKNESS:	0.489 "
THREADS PER INCH:	5

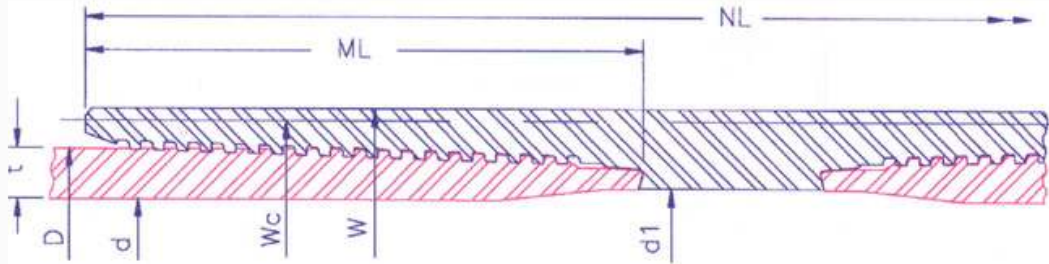

P I P E B O D Y	OUTSIDE DIA.(in)D	11.750	INSIDE DIA.(in) d	10.772	DRIFT DIA. (in)			PLAIN END WT (lb/ft)		58.81
	GRADE		K55	N80	L80	C90	C95	P110	Q125	150
	COLLAPSE RESISTANCE (psi)		2670	3170	3170	3360	3430	3600	3680	3680
	INTERNAL YIELD PRESSURE (psi)		4010	5830	5830	6550	6920	8010	9100	10920
	BODY YIELD STRENGTH (kips)		951	1384	1384	1557	1643	1903	2162	2595
	ULTIMATE STRENGTH (kips)		1643	1730	1643	1730	1816	2162	2335	2768
	YIELD TORQUE (ft/lb)		247500	360000	360000	405000	427500	495000	562500	675000

RECOMMENDED MAKEUP TORQUE USING A THREAD COMPOUND WITH FRICTION CORRECTION FACTOR OF 1.0										
M A K E U P	REGULAR	MINIMUM (ft/lb)	13700	14400	14400	14400	14400	14400	14400	14400
		OPTIMUM (ft/lb)	15200	15900	15900	15900	15900	15900	15900	15900
		MAXIMUM (ft/lb)	16700	17400	17400	17400	17400	17400	17400	17400
	SPECIAL CLEARANCE	MINIMUM (ft/lb)	13700	14400	14400	14400	14400	14400	14400	14400
		OPTIMUM (ft/lb)	15200	15900	15900	15900	15900	15900	15900	15900
		MAXIMUM (ft/lb)	16700	17400	17400	17400	17400	17400	17400	17400

C O N N E C T I O N	COLLAPSE RESISTANCE (psi)		2670	3170	3170	3360	3430	3600	3680	3680
	INTERNAL YIELD PRESSURE (psi)		4010	5830	5830	6550	6920	8010	9100	10920
	MAXIMUM LOAD OF REG. COUPLING FACE (kips)		871	1266	1266	1425	1504	1741	1979	2374
	MAXIMUM LOAD OF S.C. COUPLING FACE (kips)		325	473	473	533	562	651	740	888
	PARTING LOAD (kips)									
	REGULAR COUPLING O.D.		1208	1440	1399	1517	1596	1877	2074	2473
	SPECIAL CLEARANCE COUPLING O.D.		1099	1157	1099	1157	1215	1446	1562	1851
			OUTSIDE DIA.(in)	INSIDE DIA.(in)	WEIGHT (lb)		JOINT EFFICIENCY (%)		30' JOINT MUD DISPLACEMENT (in ²)	
	REGULAR COUPLING		W	12.772	11.023	84.06		128		6466
	SPECIAL CLEARANCE COUPLING		Wc	12.268	11.023	47.30		70		6337
	LENGTH OF COUPLING (in)		NL	13.089						
MAKE UP LOSS (in)		ML	5.589							

The above information is for reference only. The information is subject to change or modification without notice. Please contact HSC for the latest information