

# TECHNICAL INFORMATION

# CASING

|                   |            |
|-------------------|------------|
| SIZE:             | 298.45 mm  |
| NOMINAL WEIGHT:   | 96.73 kg/m |
| WALL THICKNESS:   | 13.56 mm   |
| THREADS PER INCH: | 5          |

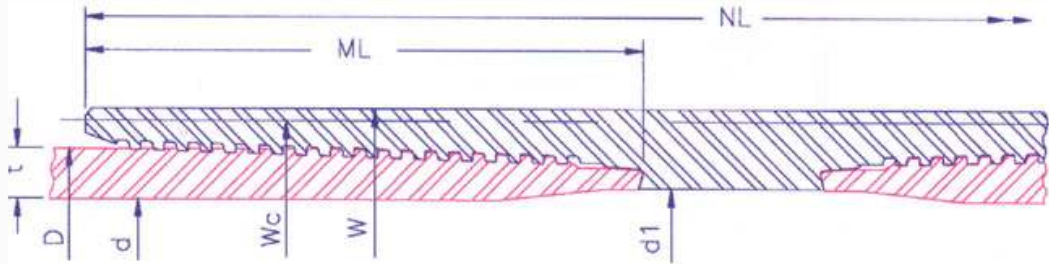

|           |                               |        |                   |        |                 |        |                     |        |        |       |
|-----------|-------------------------------|--------|-------------------|--------|-----------------|--------|---------------------|--------|--------|-------|
| PIPE BODY | OUTSIDE DIA.(mm)D             | 298.45 | INSIDE DIA.(mm) d | 271.32 | DRIFT DIA. (mm) | 267.36 | PLAIN END WT (kg/m) |        |        | 95.20 |
|           | GRADE                         | K55    |                   | N80    | L80             | C90    | C95                 | P110   | Q125   | 150   |
|           | COLLAPSE RESISTANCE (MPa)     | 22.7   | 26.7              | 26.7   | 27.9            | 28.8   | 30.8                | 32.3   | 33.3   |       |
|           | INTERNAL YIELD PRESSURE (MPa) | 30.2   | 43.9              | 43.9   | 49.4            | 52.1   | 60.3                | 68.5   | 82.3   |       |
|           | BODY YIELD STRENGTH (kN)      | 4603   | 6696              | 6696   | 7533            | 7951   | 9207                | 10462  | 12555  |       |
|           | ULTIMATE STRENGTH (kN)        | 7951   | 8370              | 7951   | 8370            | 8788   | 10462               | 11299  | 13392  |       |
|           | YIELD TORQUE (Nm)             | 362200 | 526830            | 526830 | 592680          | 625610 | 724390              | 823170 | 987810 |       |

| RECOMMENDED MAKEUP TORQUE USING A THREAD COMPOUND WITH FRICTION CORRECTION FACTOR OF 1.0 |                   |              |       |       |       |       |       |       |       |       |
|--|-------------------|--------------|-------|-------|-------|-------|-------|-------|-------|-------|
| MAKEUP   | REGULAR           | MINIMUM (Nm) | 19520 | 19520 | 19520 | 19520 | 19520 | 19520 | 19520 | 19520 |
|  |                   | OPTIMUM (Nm) | 21560 | 21560 | 21560 | 21560 | 21560 | 21560 | 21560 | 21560 |
|  |                   | MAXIMUM (Nm) | 23590 | 23590 | 23590 | 23590 | 23590 | 23590 | 23590 | 23590 |
|  | SPECIAL CLEARANCE | MINIMUM (Nm) | 19520 | 19520 | 19520 | 19520 | 19520 | 19520 | 19520 | 19520 |
|  |                   | OPTIMUM (Nm) | 21560 | 21560 | 21560 | 21560 | 21560 | 21560 | 21560 | 21560 |
|  |                   | MAXIMUM (Nm) | 23590 | 23590 | 23590 | 23590 | 23590 | 23590 | 23590 | 23590 |

|                         |   |                  |                 |             |                      |      |  |         |       |  |
|-------------------------|---|------------------|-----------------|-------------|----------------------|------|--|---------|-------|--|
| CONNECTION              | COLLAPSE RESISTANCE (MPa)               | 22.7             | 26.7            | 26.7        | 27.9                 | 28.8 | 30.8   | 32.3    | 33.3  |  |
|                         | INTERNAL YIELD PRESSURE (MPa)           | 30.2             | 43.9            | 43.9        | 49.4                 | 52.1 | 60.3   | 68.5    | 82.3  |  |
|                         | MAXIMUM LOAD OF REG. COUPLING FACE (kN) | 3873             | 5633            | 5633        | 6337                 | 6689 | 7745   | 8801    | 10562 |  |
|                         | MAXIMUM LOAD OF S.C. COUPLING FACE (kN) | 1448             | 2106            | 2106        | 2369                 | 2500 | 2895   | 3290    | 3948  |  |
|                         | PARTING LOAD (kN)                       |                  |                 |             |                      |      |  |         |       |  |
|                         | REGULAR COUPLING O.D.                   | 5843             | 6968            | 6768        | 7338                 | 7723 | 9080   | 10036   | 11963 |  |
|                         | SPECIAL CLEARANCE COUPLING O.D.         | 4888             | 5145            | 4888        | 5145                 | 5403 | 6432   | 6946    | 8232  |  |
|                         |   | OUTSIDE DIA.(mm) | INSIDE DIA.(mm) | WEIGHT (kg) | JOINT EFFICIENCY (%) |      | 30' JOINT MUD DISPLACEMENT (m <sup>3</sup> ) |         |       |  |
|                         | REGULAR COUPLING                        | W                | 324.41          | 279.98      | 38.13                | 117  |  | 0.11476 |       |  |
|                         | SPECIAL CLEARANCE COUPLING              | Wc               | 311.61          | 279.98      | 21.45                | 65   |  | 0.11263 |       |  |
| LENGTH OF COUPLING (mm) | NL                                      | 332.46           |                 |             |                      |      |  |         |       |  |
| MAKE UP LOSS (mm)       | ML                                      | 141.96           |                 |             |                      |      |  |         |       |  |

The above information is for reference only. The information is subject to change or modification without notice. Please contact HSC for the latest information