

TECHNICAL INFORMATION

CASING

SIZE:	339.72 mm
NOMINAL WEIGHT:	101.20 kg/m
WALL THICKNESS:	12.19 mm
THREADS PER INCH:	5

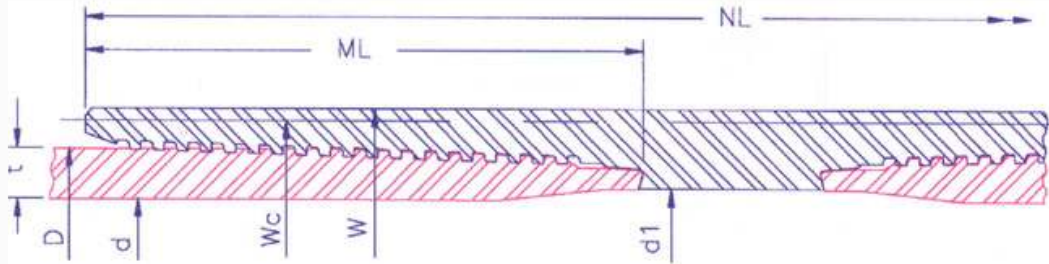

PIPE BODY	OUTSIDE DIA.(mm)D	339.72	INSIDE DIA.(mm) d	315.34	DRIFT DIA. (mm)			311.38	PLAIN END WT (kg/m)		98.37
	GRADE		K55	N80	L80	C90	C95	P110	Q125	150	
	COLLAPSE RESISTANCE (MPa)		13.4	15.6	15.6	16.0	16.1	16.1	16.1	16.1	
	INTERNAL YIELD PRESSURE (MPa)		23.8	34.6	34.6	39.0	41.1	47.6	54.1	65.0	
	BODY YIELD STRENGTH (kN)		4757	6920	6920	7785	8217	9515	10812	12974	
	ULTIMATE STRENGTH (kN)		8217	8650	8217	8650	9082	10812	11677	13839	
	YIELD TORQUE (Nm)		434270	631660	631660	710620	750090	868530	986970	1184360	

MAKEUP	RECOMMENDED MAKEUP TORQUE USING A THREAD COMPOUND WITH FRICTION CORRECTION FACTOR OF 1.0										
	REGULAR	MINIMUM (Nm)	19520	19520	19520	19520	19520	19520	19520	19520	19520
		OPTIMUM (Nm)	21560	21560	21560	21560	21560	21560	21560	21560	21560
		MAXIMUM (Nm)	23590	23590	23590	23590	23590	23590	23590	23590	23590
	SPECIAL CLEARANCE	MINIMUM (Nm)	19520	19520	19520	19520	19520	19520	19520	19520	19520
		OPTIMUM (Nm)	21560	21560	21560	21560	21560	21560	21560	21560	21560
MAXIMUM (Nm)		23590	23590	23590	23590	23590	23590	23590	23590	23590	

CONNECTION	COLLAPSE RESISTANCE (MPa)		13.4	15.6	15.6	16.0	16.1	16.1	16.1	16.1
	INTERNAL YIELD PRESSURE (MPa)		23.8	34.6	34.6	39.0	41.1	47.6	54.1	65.0
	MAXIMUM LOAD OF REG. COUPLING FACE (kN)		4387	6381	6381	7179	7578	8774	9971	11965
	MAXIMUM LOAD OF S.C. COUPLING FACE (kN)		2896	4213	4213	4739	5003	5793	6582	7899
	PARTING LOAD (kN)									
	REGULAR COUPLING O.D.		5785	7051	6873	7486	7883	9249	10259	12239
	SPECIAL CLEARANCE COUPLING O.D.		5785	7051	6873	7486	7883	9249	10259	12239
			OUTSIDE DIA.(mm)	INSIDE DIA.(mm)	WEIGHT (kg)		JOINT EFFICIENCY (%)		30' JOINT MUD DISPLACEMENT (m³)	
	REGULAR COUPLING		W	365.71	319.89	43.44		129		0.11927
	SPECIAL CLEARANCE COUPLING		Wc	358.80	319.89	33.19		98		0.11796
LENGTH OF COUPLING (mm)		NL	332.46		The above information is for reference only. The information is subject to change or modification without notice. Please contact HSC for the latest information					
MAKE UP LOSS (mm)		ML	143.31							