

TECHNICAL INFORMATION

CASING

SIZE:	13 3/8 "
NOMINAL WEIGHT:	86.00 lb/ft
WALL THICKNESS:	0.625 "
THREADS PER INCH:	5

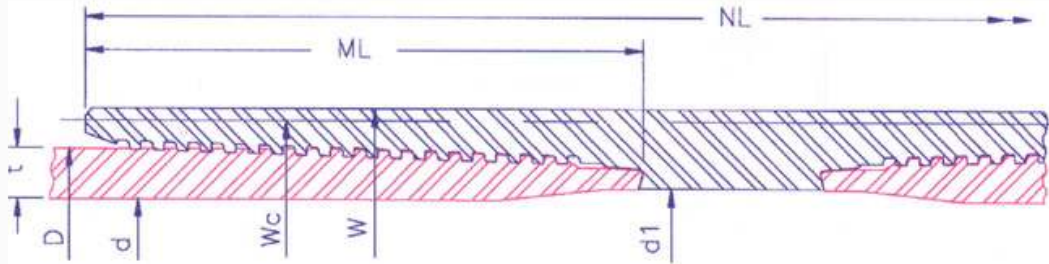

P I P E B O D Y	OUTSIDE DIA.(in)D	13.375	INSIDE DIA.(in) d		12.125	DRIFT DIA. (in)			11.969	PLAIN END WT (lb/ft)		85.11
	GRADE		K55	N80	L80	C90	C95	P110	Q125	150		
	COLLAPSE RESISTANCE (psi)		3510	4190	4190	4350	4420	4760	5020	5250		
	INTERNAL YIELD PRESSURE (psi)		4500	6540	6540	7360	7770	9000	10220	12270		
	BODY YIELD STRENGTH (kips)		1377	2003	2003	2253	2378	2754	3129	3755		
	ULTIMATE STRENGTH (kips)		2378	2503	2378	2503	2629	3129	3380	4006		
	YIELD TORQUE (ft/lb)		403600	587000	587000	660400	697000	807100	917200	1100600		

M A K E U P	RECOMMENDED MAKEUP TORQUE USING A THREAD COMPOUND WITH FRICTION CORRECTION FACTOR OF 1.0											
	REGULAR	MINIMUM (ft/lb)	14400	14400	14400	14400	14400	14400	14400	14400	14400	14400
		OPTIMUM (ft/lb)	15900	15900	15900	15900	15900	15900	15900	15900	15900	15900
		MAXIMUM (ft/lb)	17400	17400	17400	17400	17400	17400	17400	17400	17400	17400
	SPECIAL CLEARANCE	MINIMUM (ft/lb)	14400	14400	14400	14400	14400	14400	14400	14400	14400	14400
		OPTIMUM (ft/lb)	15900	15900	15900	15900	15900	15900	15900	15900	15900	15900
MAXIMUM (ft/lb)		17400	17400	17400	17400	17400	17400	17400	17400	17400	17400	

C O N N E C T I O N	COLLAPSE RESISTANCE (psi)		3510	4190	4190	4350	4420	4760	5020	5250	
	INTERNAL YIELD PRESSURE (psi)		4500	6540	6540	7360	7770	9000	10220	12270	
	MAXIMUM LOAD OF REG. COUPLING FACE (kips)		986	1435	1435	1614	1704	1973	2241	2690	
	MAXIMUM LOAD OF S.C. COUPLING FACE (kips)		651	947	947	1065	1125	1302	1480	1776	
	PARTING LOAD (kips)										
	REGULAR COUPLING O.D.		1674	2041	1989	2167	2281	2677	2969	3542	
	SPECIAL CLEARANCE COUPLING O.D.		1674	1807	1717	1807	1897	2259	2440	2891	
			OUTSIDE DIA.(in)	INSIDE DIA.(in)	WEIGHT (lb)		JOINT EFFICIENCY (%)		30' JOINT MUD DISPLACEMENT (in ³)		
	REGULAR COUPLING		W	14.398	12.594	95.76		100		9256	
	SPECIAL CLEARANCE COUPLING		Wc	14.126	12.594	73.16		76		9176	
LENGTH OF COUPLING (in)		NL	13.089								
MAKE UP LOSS (in)		ML	5.642								

The above information is for reference only. The information is subject to change or modification without notice. Please contact HSC for the latest information