

TECHNICAL INFORMATION

CASING

SIZE:	139.70 mm
NOMINAL WEIGHT:	29.76 kg/m
WALL THICKNESS:	9.17 mm
THREADS PER INCH:	5

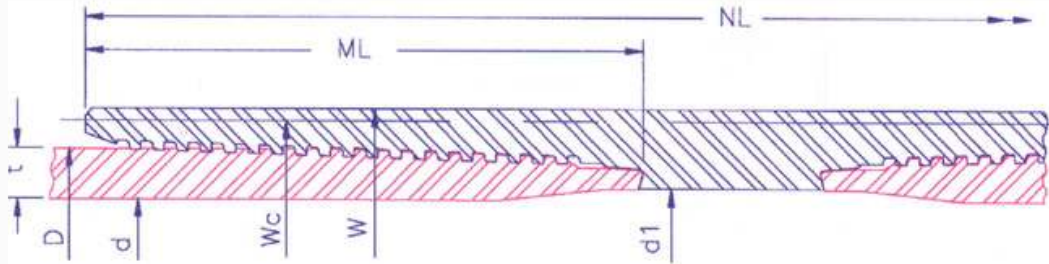

P I P E B O D Y	OUTSIDE DIA.(mm)D	139.70	INSIDE DIA.(mm) d	121.36	DRIFT DIA. (mm)			118.19	PLAIN END WT (kg/m)		29.48
	GRADE	K55		N80	L80	C90	C95	P110	Q125	150	
	COLLAPSE RESISTANCE (MPa)	45.6		60.9	60.9	66.4	69.1	76.6	83.3	92.9	
	INTERNAL YIELD PRESSURE (MPa)	43.6		63.4	63.4	71.3	75.2	87.1	99.0	118.8	
	BODY YIELD STRENGTH (kN)	1426		2074	2074	2333	2463	2852	3241	3889	
	ULTIMATE STRENGTH (kN)	2463		2593	2463	2593	2722	3241	3500	4148	
	YIELD TORQUE (Nm)	50450		73380	73380	82550	87140	100900	114660	137590	

M A K E U P	RECOMMENDED MAKEUP TORQUE USING A THREAD COMPOUND WITH FRICTION CORRECTION FACTOR OF 1.0									
	REGULAR	MINIMUM (Nm)	7240	7950	7950	8300	8300	8750	9270	9720
		OPTIMUM (Nm)	8040	8830	8830	9220	9220	9710	10290	10790
		MAXIMUM (Nm)	8840	9710	9710	10140	10140	10670	11310	11860
	SPECIAL CLEARANCE	MINIMUM (Nm)	7240	7950	7950	8300	8300	8750	9270	9720
		OPTIMUM (Nm)	8040	8830	8830	9220	9220	9710	10290	10790
MAXIMUM (Nm)		8840	9710	9710	10140	10140	10670	11310	11860	

C O N N E C T I O N	COLLAPSE RESISTANCE (MPa)		45.6	60.9	60.9	66.4	69.1	76.6	83.3	92.9
	INTERNAL YIELD PRESSURE (MPa)		43.6	63.4	63.4	71.3	75.2	87.1	99.0	118.8
	MAXIMUM LOAD OF REG. COUPLING FACE (kN)		853	1240	1240	1396	1473	1706	1938	2326
	MAXIMUM LOAD OF S.C. COUPLING FACE (kN)		428	622	622	700	738	855	972	1166
	PARTING LOAD (kN)									
	REGULAR COUPLING O.D.		2102	2331	2236	2384	2506	2967	3238	3847
	SPECIAL CLEARANCE COUPLING O.D.		1707	1797	1707	1797	1886	2246	2425	2875
			OUTSIDE DIA.(mm)	INSIDE DIA.(mm)	WEIGHT (kg)		JOINT EFFICIENCY (%)		30' JOINT MUD DISPLACEMENT (m³)	
	REGULAR COUPLING		W	154.30	124.94	9.47		103		0.03531
	SPECIAL CLEARANCE COUPLING		Wc	149.61	124.94	6.88		73		0.03498
LENGTH OF COUPLING (mm)		NL	294.46		The above information is for reference only. The information is subject to change or modification without notice. Please contact HSC for the latest information					
MAKE UP LOSS (mm)		ML	123.19							