

# TECHNICAL INFORMATION

# CASING

SIZE:	5 "
NOMINAL WEIGHT:	15.00 lb/ft
WALL THICKNESS:	0.296 "
THREADS PER INCH:	5

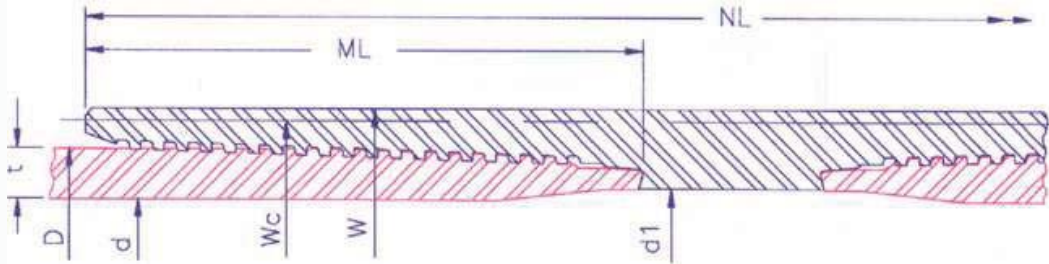

<b>P I P E  B O D Y</b>	OUTSIDE DIA.(in)D	5.000	INSIDE DIA.(in) d	4.408	DRIFT DIA. (in)			PLAIN END WT (lb/ft)		
	GRADE		K55	N80	L80	C90	C95	P110	Q125	150
	COLLAPSE RESISTANCE (psi)		5560	7250	7250	7830	8110	8850	9480	10250
	INTERNAL YIELD PRESSURE (psi)		5700	8290	8290	9320	9840	11400	12950	15540
	BODY YIELD STRENGTH (kips)		241	350	350	394	416	481	547	656
	ULTIMATE STRENGTH (kips)		416	437	416	437	459	547	591	700
	YIELD TORQUE (ft/lb)		25700	37400	37400	42100	44400	51400	58400	70100

<b>M A K E  U P</b>	RECOMMENDED MAKEUP TORQUE USING A THREAD COMPOUND WITH FRICTION CORRECTION FACTOR OF 1.0									
	REGULAR	MINIMUM (ft/lb)	4230	4630	4630	4820	4820	5020	5280	5670
		OPTIMUM (ft/lb)	4700	5140	5140	5350	5350	5570	5860	6290
		MAXIMUM (ft/lb)	5170	5650	5650	5880	5880	6120	6440	6910
	SPECIAL CLEARANCE	MINIMUM (ft/lb)	4230	4630	4630	4820	4820	5020	5280	5670
		OPTIMUM (ft/lb)	4700	5140	5140	5350	5350	5570	5860	6290
MAXIMUM (ft/lb)		5170	5650	5650	5880	5880	6120	6440	6910	

<b>C O N N E C T I O N</b>	COLLAPSE RESISTANCE (psi)		5560	7250	7250	7830	8110	8850	9480	10250	
	INTERNAL YIELD PRESSURE (psi)		5700	8290	8290	9320	9840	11400	12950	15540	
	MAXIMUM LOAD OF REG. COUPLING FACE (kips)		179	261	261	294	310	359	408	489	
	MAXIMUM LOAD OF S.C. COUPLING FACE (kips)		86	125	125	141	149	172	195	235	
			PARTING LOAD (kips)								
	REGULAR COUPLING O.D.		359	396	379	404	424	503	548	651	
	SPECIAL CLEARANCE COUPLING O.D.		345	363	345	363	381	454	490	581	
			OUTSIDE DIA.(in)	INSIDE DIA.(in)	WEIGHT (lb)		JOINT EFFICIENCY (%)		30' JOINT MUD DISPLACEMENT (in <sup>2</sup> )		
	REGULAR COUPLING	W	5.587	4.459	18.84		126		1629		
	SPECIAL CLEARANCE COUPLING	Wc	5.390	4.459	13.37		87		1610		
LENGTH OF COUPLING (in)	NL	11.357									
MAKE UP LOSS (in)	ML	4.724									

The above information is for reference only. The information is subject to change or modification without notice. Please contact HSC for the latest information