

TECHNICAL INFORMATION

CASING

SIZE:	5 "
NOMINAL WEIGHT:	18.00 lb/ft
WALL THICKNESS:	0.362 "
THREADS PER INCH:	5

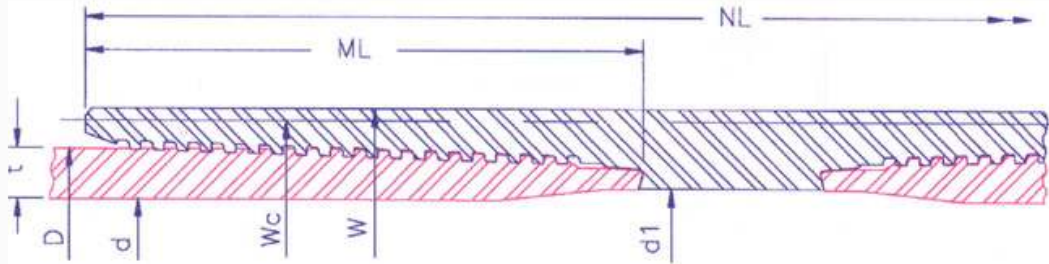

P I P E B O D Y	OUTSIDE DIA.(in)D	5.000	INSIDE DIA.(in) d		4.276	DRIFT DIA. (in)			4.151	PLAIN END WT (lb/ft)		17.93
	GRADE		K55	N80	L80	C90	C95	P110	Q125	150		
	COLLAPSE RESISTANCE (psi)		7390	10490	10490	11520	12030	13470	14820	16860		
	INTERNAL YIELD PRESSURE (psi)		6970	10140	10140	11400	12040	13940	15840	19000		
	BODY YIELD STRENGTH (kips)		290	422	422	475	501	580	659	791		
	ULTIMATE STRENGTH (kips)		501	527	501	527	554	659	712	844		
	YIELD TORQUE (ft/lb)		30200	43900	43900	49400	52200	60400	68700	82400		

M A K E U P	RECOMMENDED MAKEUP TORQUE USING A THREAD COMPOUND WITH FRICTION CORRECTION FACTOR OF 1.0										
	REGULAR	MINIMUM (ft/lb)	5140	5540	5540	5800	5800	6060	6390	6840	
		OPTIMUM (ft/lb)	5710	6150	6150	6440	6440	6730	7090	7590	
		MAXIMUM (ft/lb)	6280	6760	6760	7080	7080	7400	7790	8340	
	SPECIAL CLEARANCE	MINIMUM (ft/lb)	5140	5540	5540	5800	5800	6060	6390	6840	
		OPTIMUM (ft/lb)	5710	6150	6150	6440	6440	6730	7090	7590	
MAXIMUM (ft/lb)		6280	6760	6760	7080	7080	7400	7790	8340		

C O N N E C T I O N	COLLAPSE RESISTANCE (psi)		7390	10490	10490	11520	12030	13470	14820	16860	
	INTERNAL YIELD PRESSURE (psi)		6970	10140	10140	11400	12040	13940	15840	19000	
	MAXIMUM LOAD OF REG. COUPLING FACE (kips)		179	261	261	294	310	359	408	489	
	MAXIMUM LOAD OF S.C. COUPLING FACE (kips)		86	125	125	141	149	172	195	235	
	PARTING LOAD (kips)										
	REGULAR COUPLING O.D.		432	477	457	487	512	606	661	785	
	SPECIAL CLEARANCE COUPLING O.D.		345	363	345	363	381	454	490	581	
			OUTSIDE DIA.(in)	INSIDE DIA.(in)	WEIGHT (lb)		JOINT EFFICIENCY (%)		30' JOINT MUD DISPLACEMENT (in ³)		
	REGULAR COUPLING		W	5.587	4.419	18.99		105		1950	
	SPECIAL CLEARANCE COUPLING		Wc	5.390	4.419	13.53		72		1931	
LENGTH OF COUPLING (in)		NL	11.357		The above information is for reference only. The information is subject to change or modification without notice. Please contact HSC for the latest information						
MAKE UP LOSS (in)		ML	4.724								