

# TECHNICAL INFORMATION

# CASING

SIZE:	5 "
NOMINAL WEIGHT:	21.40 lb/ft
WALL THICKNESS:	0.437 "
THREADS PER INCH:	5

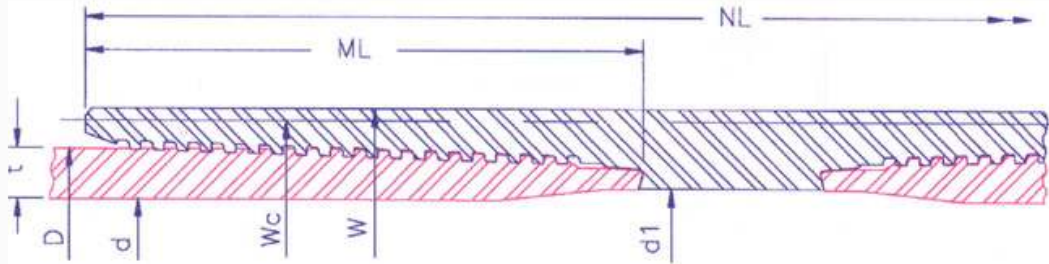

<b>P I P E  B O D Y</b>	OUTSIDE DIA.(in)D	5.000	INSIDE DIA.(in) d		4.126	DRIFT DIA. (in)			4.001	PLAIN END WT (lb/ft)	21.30
	GRADE		K55	N80	L80	C90	C95	P110	Q125	150	
	COLLAPSE RESISTANCE (psi)		8770	12760	12760	14360	15150	17550	19940	23930	
	INTERNAL YIELD PRESSURE (psi)		8410	12240	12240	13770	14530	16820	19120	22940	
	BODY YIELD STRENGTH (kips)		345	501	501	564	595	689	783	940	
	ULTIMATE STRENGTH (kips)		595	626	595	626	658	783	846	1002	
	YIELD TORQUE (ft/lb)		34800	50700	50700	57000	60200	69700	79200	95000	

<b>M A K E  U P</b>	RECOMMENDED MAKEUP TORQUE USING A THREAD COMPOUND WITH FRICTION CORRECTION FACTOR OF 1.0									
	REGULAR	MINIMUM (ft/lb)	6450	7170	7170	7470	7470	7830	8150	8780
		OPTIMUM (ft/lb)	7160	7960	7960	8300	8300	8700	9050	9750
		MAXIMUM (ft/lb)	7870	8750	8750	9130	9130	9570	9950	10720
	SPECIAL CLEARANCE	MINIMUM (ft/lb)	6450	7170	7170	7470	7470	7830	8150	8780
		OPTIMUM (ft/lb)	7160	7960	7960	8300	8300	8700	9050	9750
MAXIMUM (ft/lb)		7870	8750	8750	9130	9130	9570	9950	10720	

<b>C O N N E C T I O N</b>	COLLAPSE RESISTANCE (psi)		8770	12760	12760	14360	15150	17550	19940	23930
	INTERNAL YIELD PRESSURE (psi)		8410	12240	12240	13770	14530	16820	19120	22940
	MAXIMUM LOAD OF REG. COUPLING FACE (kips)		179	261	261	294	310	359	408	489
	MAXIMUM LOAD OF S.C. COUPLING FACE (kips)		86	125	125	141	149	172	195	235
	PARTING LOAD (kips)									
	REGULAR COUPLING O.D.		498	524	498	524	551	655	708	839
	SPECIAL CLEARANCE COUPLING O.D.		345	363	345	363	381	454	490	581
			OUTSIDE DIA.(in)	INSIDE DIA.(in)	WEIGHT (lb)		JOINT EFFICIENCY (%)		30' JOINT MUD DISPLACEMENT (in <sup>2</sup> )	
	REGULAR COUPLING		W	5.587	4.313	19.41		88		2305
	SPECIAL CLEARANCE COUPLING		Wc	5.390	4.313	13.94		61		2286
LENGTH OF COUPLING (in)		NL	11.357							
MAKE UP LOSS (in)		ML	4.724							

The above information is for reference only. The information is subject to change or modification without notice. Please contact HSC for the latest information