

TECHNICAL INFORMATION

CASING

| | |
|-------------------|------------|
| SIZE: | 127.00 mm |
| NOMINAL WEIGHT: | 22.32 kg/m |
| WALL THICKNESS: | 7.52 mm |
| THREADS PER INCH: | 5 |

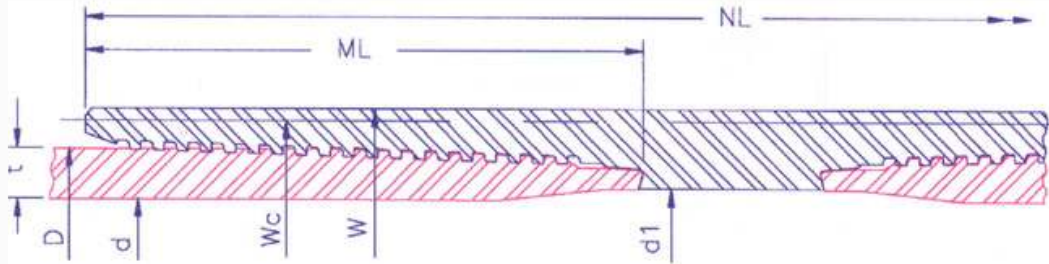

| | | | | | | | | | | |
|---|-------------------------------|--------|-------------------|--------|-----------------|--------|---------------------|-------|-------|-------|
| P I P E B O D Y | OUTSIDE DIA.(mm)D | 127.00 | INSIDE DIA.(mm) d | 111.96 | DRIFT DIA. (mm) | 108.79 | PLAIN END WT (kg/m) | | | 22.13 |
| | GRADE | | K55 | N80 | L80 | C90 | C95 | P110 | Q125 | 150 |
| | COLLAPSE RESISTANCE (MPa) | | 38.3 | 50.0 | 50.0 | 54.0 | 55.9 | 61.0 | 65.4 | 70.7 |
| | INTERNAL YIELD PRESSURE (MPa) | | 39.3 | 57.1 | 57.1 | 64.3 | 67.9 | 78.6 | 89.3 | 107.1 |
| | BODY YIELD STRENGTH (kN) | | 1070 | 1557 | 1557 | 1751 | 1848 | 2140 | 2432 | 2919 |
| | ULTIMATE STRENGTH (kN) | | 1848 | 1946 | 1848 | 1946 | 2043 | 2432 | 2627 | 3113 |
| | YIELD TORQUE (Nm) | | 34860 | 50710 | 50710 | 57050 | 60220 | 69730 | 79240 | 95080 |

| | | | | | | | | | | |
|---|--|--------------|------|------|------|------|------|------|------|------|
| M A K E U P | RECOMMENDED MAKEUP TORQUE USING A THREAD COMPOUND WITH FRICTION CORRECTION FACTOR OF 1.0 | | | | | | | | | |
| | REGULAR | MINIMUM (Nm) | 5740 | 6280 | 6280 | 6540 | 6540 | 6810 | 7160 | 7690 |
| | | OPTIMUM (Nm) | 6370 | 6970 | 6970 | 7250 | 7250 | 7550 | 7950 | 8530 |
| | | MAXIMUM (Nm) | 7010 | 7660 | 7660 | 7970 | 7970 | 8300 | 8730 | 9370 |
| | SPECIAL CLEARANCE | MINIMUM (Nm) | 5740 | 6280 | 6280 | 6540 | 6540 | 6810 | 7160 | 7690 |
| | | OPTIMUM (Nm) | 6370 | 6970 | 6970 | 7250 | 7250 | 7550 | 7950 | 8530 |
| MAXIMUM (Nm) | | 7010 | 7660 | 7660 | 7970 | 7970 | 8300 | 8730 | 9370 | |

| | | | | | | | | | | |
|--|---|----|------------------|-----------------|-------------|------|----------------------|------|---------------------------------|---------|
| C O N N E C T I O N | COLLAPSE RESISTANCE (MPa) | | 38.3 | 50.0 | 50.0 | 54.0 | 55.9 | 61.0 | 65.4 | 70.7 |
| | INTERNAL YIELD PRESSURE (MPa) | | 39.3 | 57.1 | 57.1 | 64.3 | 67.9 | 78.6 | 89.3 | 107.1 |
| | MAXIMUM LOAD OF REG. COUPLING FACE (kN) | | 798 | 1161 | 1161 | 1306 | 1379 | 1596 | 1814 | 2177 |
| | MAXIMUM LOAD OF S.C. COUPLING FACE (kN) | | 383 | 557 | 557 | 626 | 661 | 765 | 870 | 1044 |
| | PARTING LOAD (kN) | | | | | | | | | |
| | REGULAR COUPLING O.D. | | 1595 | 1760 | 1686 | 1796 | 1888 | 2236 | 2438 | 2896 |
| | SPECIAL CLEARANCE COUPLING O.D. | | 1534 | 1615 | 1534 | 1615 | 1696 | 2019 | 2180 | 2584 |
| | | | OUTSIDE DIA.(mm) | INSIDE DIA.(mm) | WEIGHT (kg) | | JOINT EFFICIENCY (%) | | 30' JOINT MUD DISPLACEMENT (m³) | |
| | REGULAR COUPLING | | W | 141.91 | 113.26 | 8.54 | | 126 | | 0.02669 |
| | SPECIAL CLEARANCE COUPLING | | Wc | 136.91 | 113.26 | 6.07 | | 87 | | 0.02638 |
| LENGTH OF COUPLING (mm) | | NL | 288.47 | | | | | | | |
| MAKE UP LOSS (mm) | | ML | 119.99 | | | | | | | |

The above information is for reference only. The information is subject to change or modification without notice. Please contact HSC for the latest information