

TECHNICAL INFORMATION

CASING

SIZE:	168.28 mm
NOMINAL WEIGHT:	41.67 kg/m
WALL THICKNESS:	10.59 mm
THREADS PER INCH:	5

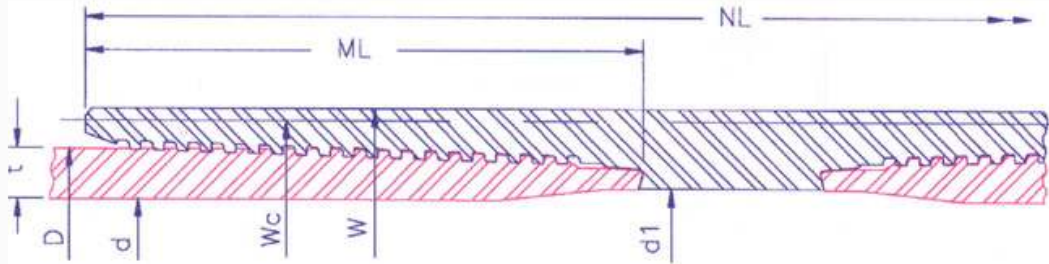

P I P E B O D Y	OUTSIDE DIA.(mm)D	168.28	INSIDE DIA.(mm) d	147.09	DRIFT DIA. (mm)			PLAIN END WT (kg/m)		41.15
	GRADE	K55		N80	L80	C90	C95	P110	Q125	150
	COLLAPSE RESISTANCE (MPa)	42.6		56.3	56.3	61.2	63.6	70.1	75.8	83.6
	INTERNAL YIELD PRESSURE (MPa)	41.8		60.8	60.8	68.4	72.1	83.5	94.9	113.9
	BODY YIELD STRENGTH (kN)	1990		2894	2894	3256	3437	3979	4522	5426
	ULTIMATE STRENGTH (kN)	3437		3618	3437	3618	3799	4522	4884	5788
	YIELD TORQUE (Nm)	85250		124000	124000	139500	147250	170500	193750	232500

M A K E U P	RECOMMENDED MAKEUP TORQUE USING A THREAD COMPOUND WITH FRICTION CORRECTION FACTOR OF 1.0									
	REGULAR	MINIMUM (Nm)	10620	11900	11900	12880	12880	13690	14170	15860
		OPTIMUM (Nm)	11800	13220	13220	14240	14240	15190	15660	17630
		MAXIMUM (Nm)	12980	14530	14530	15590	15590	16680	17150	19390
	SPECIAL CLEARANCE	MINIMUM (Nm)	10620	11900	11900	12880	12880	13690	14170	15860
		OPTIMUM (Nm)	11800	13220	13220	14240	14240	15190	15660	17630
MAXIMUM (Nm)		12980	14530	14530	15590	15590	16680	17150	19390	

C O N N E C T I O N	COLLAPSE RESISTANCE (MPa)		42.6	56.3	56.3	61.2	63.6	70.1	75.8	83.6
	INTERNAL YIELD PRESSURE (MPa)		41.8	60.8	60.8	68.4	72.1	83.5	94.9	113.9
	MAXIMUM LOAD OF REG. COUPLING FACE (kN)		1745	2538	2538	2855	3013	3489	3965	4758
	MAXIMUM LOAD OF S.C. COUPLING FACE (kN)		644	936	936	1054	1112	1288	1463	1756
	PARTING LOAD (kN)									
	REGULAR COUPLING O.D.		2859	3209	3085	3299	3469	4102	4486	5333
	SPECIAL CLEARANCE COUPLING O.D.		2084	2194	2084	2194	2303	2742	2961	3510
			OUTSIDE DIA.(mm)	INSIDE DIA.(mm)	WEIGHT (kg)		JOINT EFFICIENCY (%)		30' JOINT MUD DISPLACEMENT (m³)	
	REGULAR COUPLING		W	188.29	151.26	14.19		119		0.04956
	SPECIAL CLEARANCE COUPLING		Wc	178.21	151.26	7.35		64		0.04869
LENGTH OF COUPLING (mm)		NL	300.46							
MAKE UP LOSS (mm)		ML	126.11							

The above information is for reference only. The information is subject to change or modification without notice. Please contact HSC for the latest information