

# TECHNICAL INFORMATION

# CASING

SIZE:	177.80 mm
NOMINAL WEIGHT:	47.62 kg/m
WALL THICKNESS:	11.51 mm
THREADS PER INCH:	5

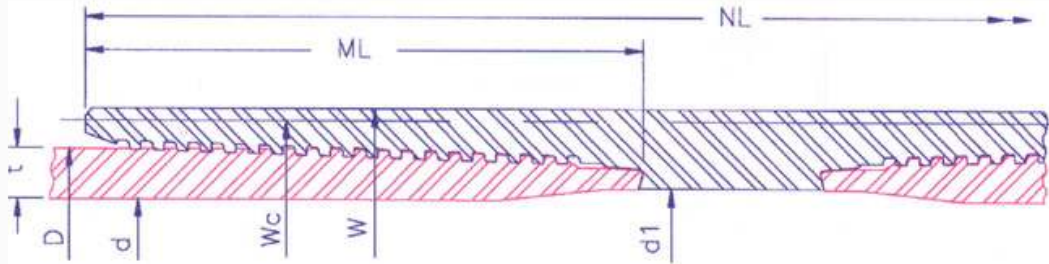

<b>P I P E  B O D Y</b>	OUTSIDE DIA.(mm)D	177.80	INSIDE DIA.(mm) d	154.79	DRIFT DIA. (mm)			PLAIN END WT (kg/m)		47.13
	GRADE	K55		N80	L80	C90	C95	P110	Q125	150
	COLLAPSE RESISTANCE (MPa)	44.6		59.3	59.3	64.6	67.2	74.3	80.7	89.7
	INTERNAL YIELD PRESSURE (MPa)	42.9		62.5	62.5	70.3	74.2	85.9	97.6	117.1
	BODY YIELD STRENGTH (kN)	2279		3316	3316	3730	3937	4559	5181	6217
	ULTIMATE STRENGTH (kN)	3937		4145	3937	4145	4352	5181	5595	6631
	YIELD TORQUE (Nm)	102840		149580	149580	168280	177630	205670	233720	280460

<b>M A K E  U P</b>	RECOMMENDED MAKEUP TORQUE USING A THREAD COMPOUND WITH FRICTION CORRECTION FACTOR OF 1.0									
	REGULAR	MINIMUM (Nm)	11050	12410	12410	13350	13350	14170	15050	16410
		OPTIMUM (Nm)	12270	13760	13760	14710	14710	15660	16680	18170
		MAXIMUM (Nm)	13490	15120	15120	16070	16070	17150	18300	19930
	SPECIAL CLEARANCE	MINIMUM (Nm)	11050	12410	12410	13350	13350	14170	15050	16410
		OPTIMUM (Nm)	12270	13760	13760	14710	14710	15660	16680	18170
MAXIMUM (Nm)		13490	15120	15120	16070	16070	17150	18300	19930	

<b>C O N N E C T I O N</b>	COLLAPSE RESISTANCE (MPa)		44.6	59.3	59.3	64.6	67.2	74.3	80.7	89.7
	INTERNAL YIELD PRESSURE (MPa)		42.9	62.5	62.5	70.3	74.2	85.9	97.6	117.1
	MAXIMUM LOAD OF REG. COUPLING FACE (kN)		1384	2013	2013	2264	2390	2767	3145	3774
	MAXIMUM LOAD OF S.C. COUPLING FACE (kN)		541	787	787	885	934	1082	1229	1475
	PARTING LOAD (kN)									
	REGULAR COUPLING O.D.		3248	3660	3521	3769	3963	4684	5126	6096
	SPECIAL CLEARANCE COUPLING O.D.		2264	2383	2264	2383	2503	2979	3218	3814
			OUTSIDE DIA.(mm)	INSIDE DIA.(mm)	WEIGHT (kg)		JOINT EFFICIENCY (%)		30' JOINT MUD DISPLACEMENT (m³)	
	REGULAR COUPLING		W	195.10	161.04	15.03		98		0.05638
	SPECIAL CLEARANCE COUPLING		Wc	187.71	161.04	9.57		61		0.05568
LENGTH OF COUPLING (mm)		NL	313.46							
MAKE UP LOSS (mm)		ML	132.79							

The above information is for reference only. The information is subject to change or modification without notice. Please contact HSC for the latest information