

# TECHNICAL INFORMATION

# CASING

SIZE:	244.48 mm
NOMINAL WEIGHT:	59.53 kg/m
WALL THICKNESS:	10.03 mm
THREADS PER INCH:	5

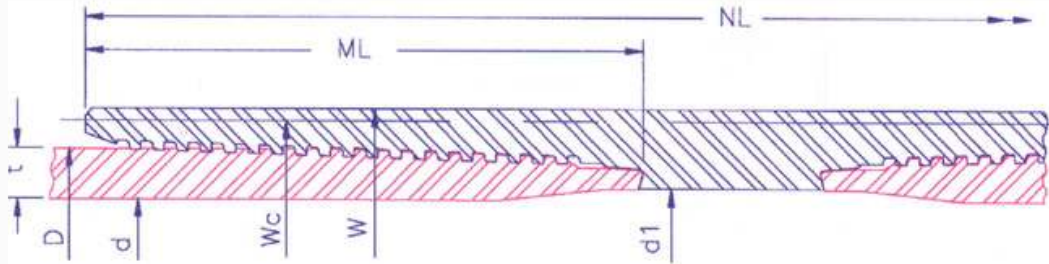

PIPE BODY	OUTSIDE DIA.(mm)D	244.48	INSIDE DIA.(mm) d	224.41	DRIFT DIA. (mm)			PLAIN END WT (kg/m)		
					220.45					
	GRADE		K55	N80	L80	C90	C95	P110	Q125	150
	COLLAPSE RESISTANCE (MPa)		17.7	21.3	21.3	22.4	22.9	23.9	24.3	24.3
	INTERNAL YIELD PRESSURE (MPa)		27.2	39.6	39.6	44.6	47.0	54.5	61.9	74.3
	BODY YIELD STRENGTH (kN)		2802	4076	4076	4585	4840	5604	6369	7642
	ULTIMATE STRENGTH (kN)		4840	5095	4840	5095	5350	6369	6878	8152
YIELD TORQUE (Nm)		182200	265010	265010	298140	314700	364390	414080	496900	

MAKEUP	RECOMMENDED MAKEUP TORQUE USING A THREAD COMPOUND WITH FRICTION CORRECTION FACTOR OF 1.0									
	REGULAR	MINIMUM (Nm)	12880	15050	15050	16410	16410	17690	19520	19520
		OPTIMUM (Nm)	14240	16680	16680	18170	18170	19590	21560	21560
		MAXIMUM (Nm)	15590	18300	18300	19930	19930	21490	23590	23590
	SPECIAL CLEARANCE	MINIMUM (Nm)	12880	15050	15050	16410	16410	17690	19520	19520
		OPTIMUM (Nm)	14240	16680	16680	18170	18170	19590	21560	21560
MAXIMUM (Nm)		15590	18300	18300	19930	19930	21490	23590	23590	

CONNECTION	COLLAPSE RESISTANCE (MPa)		17.7	21.3	21.3	22.4	22.9	23.9	24.3	24.3
	INTERNAL YIELD PRESSURE (MPa)		27.2	39.6	39.6	44.6	47.0	54.5	61.9	74.3
	MAXIMUM LOAD OF REG. COUPLING FACE (kN)		3216	4677	4677	5262	5554	6431	7308	8770
	MAXIMUM LOAD OF S.C. COUPLING FACE (kN)		1186	1725	1725	1941	2049	2372	2695	3235
	PARTING LOAD (kN)									
	REGULAR COUPLING O.D.		3752	4357	4213	4541	4778	5630	6195	7377
	SPECIAL CLEARANCE COUPLING O.D.		3752	4204	3994	4204	4414	5255	5676	6727
			OUTSIDE DIA.(mm)	INSIDE DIA.(mm)	WEIGHT (kg)		JOINT EFFICIENCY (%)		30' JOINT MUD DISPLACEMENT (m³)	
	REGULAR COUPLING		W	270.51	228.35	30.87		159		0.07090
	SPECIAL CLEARANCE COUPLING		Wc	257.61	228.35	17.04		87		0.06913
LENGTH OF COUPLING (mm)		NL	329.46							
MAKE UP LOSS (mm)		ML	140.84							

The above information is for reference only. The information is subject to change or modification without notice. Please contact HSC for the latest information