

TECHNICAL INFORMATION

CASING

SIZE:	244.48 mm
NOMINAL WEIGHT:	64.74 kg/m
WALL THICKNESS:	11.05 mm
THREADS PER INCH:	5

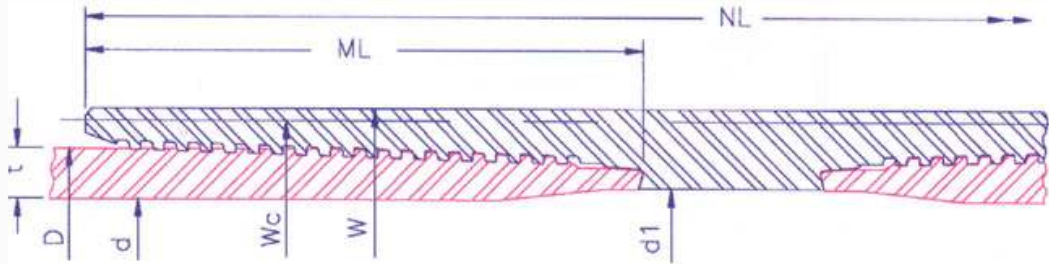

P I P E B O D Y	OUTSIDE DIA.(mm)D	244.48	INSIDE DIA.(mm) d	222.38	DRIFT DIA. (mm)	218.41	PLAIN END WT (kg/m)			63.53
	GRADE		K55	N80	L80	C90	C95	P110	Q125	150
	COLLAPSE RESISTANCE (MPa)		22.4	26.3	26.3	27.6	28.4	30.4	31.8	32.8
	INTERNAL YIELD PRESSURE (MPa)		30.0	43.6	43.6	49.1	51.8	60.0	68.2	81.8
	BODY YIELD STRENGTH (kN)		3073	4469	4469	5028	5307	6145	6983	8380
	ULTIMATE STRENGTH (kN)		5307	5587	5307	5587	5866	6983	7542	8938
	YIELD TORQUE (Nm)		198130	288190	288190	324210	342220	396260	450290	540350

RECOMMENDED MAKEUP TORQUE USING A THREAD COMPOUND WITH FRICTION CORRECTION FACTOR OF 1.0										
M A K E U P	REGULAR	MINIMUM (Nm)	14710	17220	17220	18570	18570	19520	19520	19520
		OPTIMUM (Nm)	16200	19120	19120	20610	20610	21560	21560	21560
		MAXIMUM (Nm)	17690	21020	21020	22640	22640	23590	23590	23590
	SPECIAL CLEARANCE	MINIMUM (Nm)	14710	17220	17220	18570	18570	19520	19520	19520
		OPTIMUM (Nm)	16200	19120	19120	20610	20610	21560	21560	21560
		MAXIMUM (Nm)	17690	21020	21020	22640	22640	23590	23590	23590

C O N N E C T I O N	COLLAPSE RESISTANCE (MPa)		22.4	26.3	26.3	27.6	28.4	30.4	31.8	32.8
	INTERNAL YIELD PRESSURE (MPa)		30.0	43.6	43.6	49.1	51.8	60.0	68.2	81.8
	MAXIMUM LOAD OF REG. COUPLING FACE (kN)		3216	4677	4677	5262	5554	6431	7308	8770
	MAXIMUM LOAD OF S.C. COUPLING FACE (kN)		1186	1725	1725	1941	2049	2372	2695	3235
	PARTING LOAD (kN)									
	REGULAR COUPLING O.D.		4114	4777	4619	4979	5239	6174	6793	8089
	SPECIAL CLEARANCE COUPLING O.D.		3994	4204	3994	4204	4414	5255	5676	6727
			OUTSIDE DIA.(mm)	INSIDE DIA.(mm)	WEIGHT (kg)		JOINT EFFICIENCY (%)		30' JOINT MUD DISPLACEMENT (m³)	
	REGULAR COUPLING		W	270.51	227.25	31.02		145		0.07738
	SPECIAL CLEARANCE COUPLING		Wc	257.61	227.25	17.20		79		0.07561
LENGTH OF COUPLING (mm)		NL	329.46							
MAKE UP LOSS (mm)		ML	140.84							

The above information is for reference only. The information is subject to change or modification without notice. Please contact HSC for the latest information