

TECHNICAL INFORMATION

CASING

SIZE:	244.48 mm
NOMINAL WEIGHT:	79.62 kg/m
WALL THICKNESS:	13.84 mm
THREADS PER INCH:	5

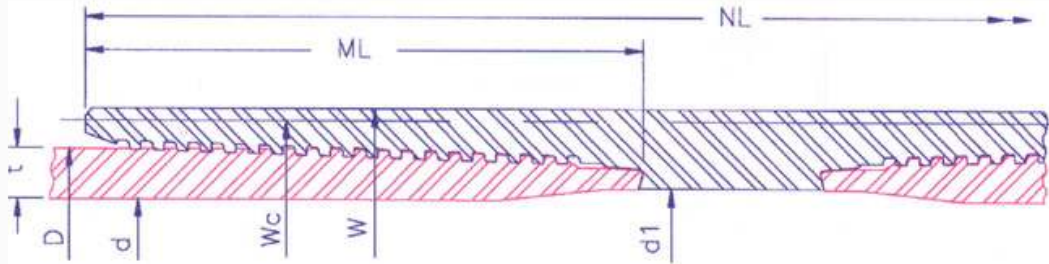

P I P E B O D Y	OUTSIDE DIA.(mm)D	244.48	INSIDE DIA.(mm) d	216.79	DRIFT DIA. (mm)			212.83	PLAIN END WT (kg/m)		78.65
	GRADE		K55	N80	L80	C90	C95	P110	Q125	150	
	COLLAPSE RESISTANCE (MPa)		35.4	45.6	45.6	49.1	50.6	54.8	58.2	61.8	
	INTERNAL YIELD PRESSURE (MPa)		37.6	54.7	54.7	61.5	64.9	75.2	85.4	102.5	
	BODY YIELD STRENGTH (kN)		3803	5532	5532	6224	6570	7607	8644	10373	
	ULTIMATE STRENGTH (kN)		6570	6915	6570	6915	7261	8644	9336	11065	
	YIELD TORQUE (Nm)		239750	348730	348730	392320	414110	479500	544880	653860	

M A K E U P	RECOMMENDED MAKEUP TORQUE USING A THREAD COMPOUND WITH FRICTION CORRECTION FACTOR OF 1.0										
	REGULAR	MINIMUM (Nm)	16410	19520	19520	19520	19520	19520	19520	19520	19520
		OPTIMUM (Nm)	18170	21560	21560	21560	21560	21560	21560	21560	21560
		MAXIMUM (Nm)	19930	23590	23590	23590	23590	23590	23590	23590	23590
	SPECIAL CLEARANCE	MINIMUM (Nm)	16410	19520	19520	19520	19520	19520	19520	19520	19520
		OPTIMUM (Nm)	18170	21560	21560	21560	21560	21560	21560	21560	21560
MAXIMUM (Nm)		19930	23590	23590	23590	23590	23590	23590	23590	23590	

C O N N E C T I O N	COLLAPSE RESISTANCE (MPa)		35.4	45.6	45.6	49.1	50.6	54.8	58.2	61.8
	INTERNAL YIELD PRESSURE (MPa)		37.6	54.7	54.7	61.5	64.9	75.2	85.4	102.5
	MAXIMUM LOAD OF REG. COUPLING FACE (kN)		3216	4677	4677	5262	5554	6431	7308	8770
	MAXIMUM LOAD OF S.C. COUPLING FACE (kN)		1186	1725	1725	1941	2049	2372	2695	3235
	PARTING LOAD (kN)									
	REGULAR COUPLING O.D.		5092	5914	5718	6164	6485	7642	8409	10013
	SPECIAL CLEARANCE COUPLING O.D.		3994	4204	3994	4204	4414	5255	5676	6727
			OUTSIDE DIA.(mm)	INSIDE DIA.(mm)	WEIGHT (kg)		JOINT EFFICIENCY (%)		30' JOINT MUD DISPLACEMENT (m ³)	
	REGULAR COUPLING		W	270.51	227.25	31.02		117		0.09470
	SPECIAL CLEARANCE COUPLING		Wc	257.61	227.25	17.20		64		0.09294
LENGTH OF COUPLING (mm)		NL	329.46							
MAKE UP LOSS (mm)		ML	140.84							

The above information is for reference only. The information is subject to change or modification without notice. Please contact HSC for the latest information