

TECHNICAL INFORMATION

CASING

SIZE:	11 3/4 "
NOMINAL WEIGHT:	47.00 lb/ft
WALL THICKNESS:	0.375 "
THREADS PER INCH:	5

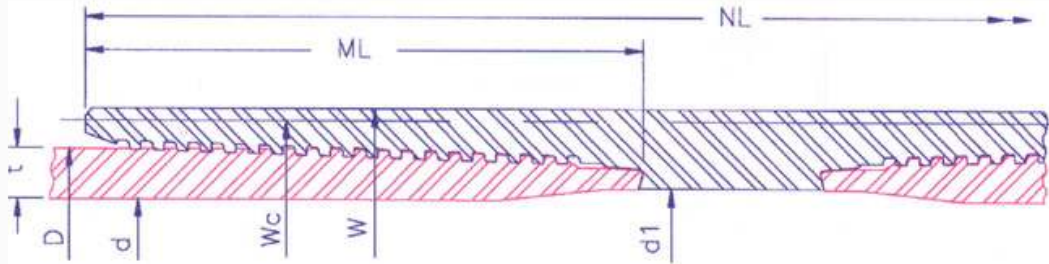

P I P E B O D Y	OUTSIDE DIA.(in)D	11.750	INSIDE DIA.(in) d		11.000	DRIFT DIA. (in)			10.844	PLAIN END WT (lb/ft)		45.56	
	GRADE		K55	N80	L80	C90	C95	P110	Q125	150			
	COLLAPSE RESISTANCE (psi)		1510	1630	1630	1630	1630	1630	1630	1630	1630		
	INTERNAL YIELD PRESSURE (psi)		3070	4470	4470	5030	5310	6140	6980	8380			
	BODY YIELD STRENGTH (kips)		737	1072	1072	1206	1273	1474	1675	2010			
	ULTIMATE STRENGTH (kips)		1273	1340	1273	1340	1407	1675	1809	2144			
	YIELD TORQUE (ft/lb)		195500	284300	284300	319800	337600	390900	444200	533100			

RECOMMENDED MAKEUP TORQUE USING A THREAD COMPOUND WITH FRICTION CORRECTION FACTOR OF 1.0										
M A K E U P	REGULAR	MINIMUM (ft/lb)	9500	11450	11450	12700	12700	13700	14400	14400
		OPTIMUM (ft/lb)	10500	12650	12650	14100	14100	15200	15900	15900
		MAXIMUM (ft/lb)	11500	13850	13850	15500	15500	16700	17400	17400
	SPECIAL CLEARANCE	MINIMUM (ft/lb)	9500	11450	11450	12700	12700	13700	14400	14400
		OPTIMUM (ft/lb)	10500	12650	12650	14100	14100	15200	15900	15900
		MAXIMUM (ft/lb)	11500	13850	13850	15500	15500	16700	17400	17400

C O N N E C T I O N	COLLAPSE RESISTANCE (psi)		1510	1630	1630	1630	1630	1630	1630	1630
	INTERNAL YIELD PRESSURE (psi)		3070	4470	4470	5030	5310	6140	6980	8380
	MAXIMUM LOAD OF REG. COUPLING FACE (kips)		871	1266	1266	1425	1504	1741	1979	2374
	MAXIMUM LOAD OF S.C. COUPLING FACE (kips)		325	473	473	533	562	651	740	888
	PARTING LOAD (kips)									
	REGULAR COUPLING O.D.		935	1116	1084	1175	1237	1454	1607	1915
	SPECIAL CLEARANCE COUPLING O.D.		935	1116	1084	1157	1215	1446	1562	1851
			OUTSIDE DIA.(in)	INSIDE DIA.(in)	WEIGHT (lb)		JOINT EFFICIENCY (%)		30' JOINT MUD DISPLACEMENT (in ²)	
	REGULAR COUPLING		W	12.772	11.108	83.22		165		5075
	SPECIAL CLEARANCE COUPLING		Wc	12.268	11.108	46.46		91		4945
LENGTH OF COUPLING (in)		NL	13.089							
MAKE UP LOSS (in)		ML	5.589							

The above information is for reference only. The information is subject to change or modification without notice. Please contact HSC for the latest information