

TECHNICAL INFORMATION

CASING

| | |
|-------------------|-------------|
| SIZE: | 339.72 mm |
| NOMINAL WEIGHT: | 107.15 kg/m |
| WALL THICKNESS: | 13.06 mm |
| THREADS PER INCH: | 5 |

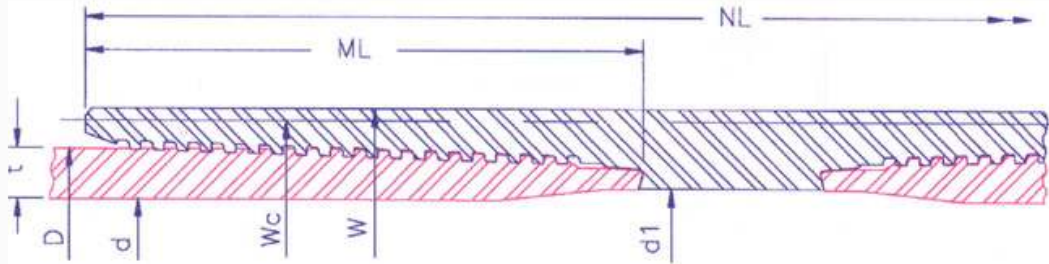

| | | | | | | | | | | |
|-----------|-------------------------------|--------|-------------------|--------|-----------------|--------|--------|---------------------|---------|---------|
| PIPE BODY | OUTSIDE DIA.(mm)D | 339.72 | INSIDE DIA.(mm) d | 313.61 | DRIFT DIA. (mm) | | 309.65 | PLAIN END WT (kg/m) | | 105.06 |
| | GRADE | | K55 | N80 | L80 | C90 | C95 | P110 | Q125 | 150 |
| | COLLAPSE RESISTANCE (MPa) | | 15.3 | 18.4 | 18.4 | 19.2 | 19.4 | 19.8 | 19.9 | 19.9 |
| | INTERNAL YIELD PRESSURE (MPa) | | 25.5 | 37.1 | 37.1 | 41.7 | 44.1 | 51.0 | 58.0 | 69.6 |
| | BODY YIELD STRENGTH (kN) | | 5081 | 7390 | 7390 | 8314 | 8776 | 10162 | 11547 | 13857 |
| | ULTIMATE STRENGTH (kN) | | 8776 | 9238 | 8776 | 9238 | 9700 | 11547 | 12471 | 14781 |
| | YIELD TORQUE (Nm) | | 461450 | 671210 | 671210 | 755110 | 797060 | 922910 | 1048760 | 1258510 |

| | | | | | | | | | | | |
|--------------|--|--------------|-------|-------|-------|-------|-------|-------|-------|-------|-------|
| MAKEUP | RECOMMENDED MAKEUP TORQUE USING A THREAD COMPOUND WITH FRICTION CORRECTION FACTOR OF 1.0 | | | | | | | | | | |
| | REGULAR | MINIMUM (Nm) | 19520 | 19520 | 19520 | 19520 | 19520 | 19520 | 19520 | 19520 | 19520 |
| | | OPTIMUM (Nm) | 21560 | 21560 | 21560 | 21560 | 21560 | 21560 | 21560 | 21560 | 21560 |
| | | MAXIMUM (Nm) | 23590 | 23590 | 23590 | 23590 | 23590 | 23590 | 23590 | 23590 | 23590 |
| | SPECIAL CLEARANCE | MINIMUM (Nm) | 19520 | 19520 | 19520 | 19520 | 19520 | 19520 | 19520 | 19520 | 19520 |
| | | OPTIMUM (Nm) | 21560 | 21560 | 21560 | 21560 | 21560 | 21560 | 21560 | 21560 | 21560 |
| MAXIMUM (Nm) | | 23590 | 23590 | 23590 | 23590 | 23590 | 23590 | 23590 | 23590 | 23590 | |

| | | | | | | | | | | |
|-------------------------|---|----|------------------|-----------------|-------------|-------|----------------------|------|---------------------------------|---------|
| CONNECTION | COLLAPSE RESISTANCE (MPa) | | 15.3 | 18.4 | 18.4 | 19.2 | 19.4 | 19.8 | 19.9 | 19.9 |
| | INTERNAL YIELD PRESSURE (MPa) | | 25.5 | 37.1 | 37.1 | 41.7 | 44.1 | 51.0 | 58.0 | 69.6 |
| | MAXIMUM LOAD OF REG. COUPLING FACE (kN) | | 4387 | 6381 | 6381 | 7179 | 7578 | 8774 | 9971 | 11965 |
| | MAXIMUM LOAD OF S.C. COUPLING FACE (kN) | | 2896 | 4213 | 4213 | 4739 | 5003 | 5793 | 6582 | 7899 |
| | PARTING LOAD (kN) | | | | | | | | | |
| | REGULAR COUPLING O.D. | | 6178 | 7531 | 7340 | 7996 | 8419 | 9878 | 10957 | 13072 |
| | SPECIAL CLEARANCE COUPLING O.D. | | 6178 | 7531 | 7340 | 7996 | 8419 | 9878 | 10852 | 12861 |
| | | | OUTSIDE DIA.(mm) | INSIDE DIA.(mm) | WEIGHT (kg) | | JOINT EFFICIENCY (%) | | 30' JOINT MUD DISPLACEMENT (m³) | |
| | REGULAR COUPLING | | W | 365.71 | 319.89 | 43.44 | | 121 | | 0.12696 |
| | SPECIAL CLEARANCE COUPLING | | Wc | 358.80 | 319.89 | 33.19 | | 92 | | 0.12565 |
| LENGTH OF COUPLING (mm) | | NL | 332.46 | | | | | | | |
| MAKE UP LOSS (mm) | | ML | 143.31 | | | | | | | |

The above information is for reference only. The information is subject to change or modification without notice. Please contact HSC for the latest information