

TECHNICAL INFORMATION

CASING

SIZE:	139.70 mm
NOMINAL WEIGHT:	38.69 kg/m
WALL THICKNESS:	12.09 mm
THREADS PER INCH:	5

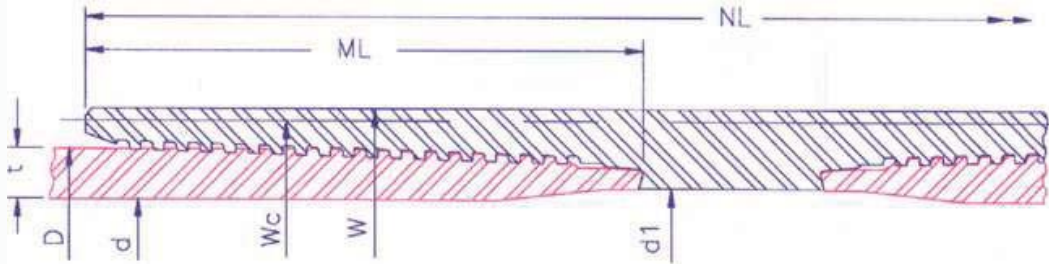

P I P E B O D Y	OUTSIDE DIA.(mm)D	139.70	INSIDE DIA.(mm) d	115.52	DRIFT DIA. (mm)			112.34	PLAIN END WT (kg/m)		38.01
	GRADE		K55	N80	L80	C90	C95	P110	Q125	150	
	COLLAPSE RESISTANCE (MPa)		60.0	87.2	87.2	98.1	103.6	119.9	136.3	163.5	
	INTERNAL YIELD PRESSURE (MPa)		57.4	83.5	83.5	94.0	99.2	114.9	130.5	156.6	
	BODY YIELD STRENGTH (kN)		1838	2674	2674	3008	3175	3676	4177	5013	
	ULTIMATE STRENGTH (kN)		3175	3342	3175	3342	3509	4177	4512	5347	
	YIELD TORQUE (Nm)		62400	90770	90770	102120	107790	124810	141830	170190	

RECOMMENDED MAKEUP TORQUE USING A THREAD COMPOUND WITH FRICTION CORRECTION FACTOR OF 1.0										
M A K E U P	REGULAR	MINIMUM (Nm)	9270	10130	10130	11050	11050	11470	11900	13350
		OPTIMUM (Nm)	10290	11250	11250	12270	12270	12740	13220	14710
		MAXIMUM (Nm)	11310	12380	12380	13490	13490	14020	14530	16070
	SPECIAL CLEARANCE	MINIMUM (Nm)	9270	10130	10130	11050	11050	11470	11900	13350
		OPTIMUM (Nm)	10290	11250	11250	12270	12270	12740	13220	14710
		MAXIMUM (Nm)	11310	12380	12380	13490	13490	14020	14530	16070

C O N N E C T I O N	COLLAPSE RESISTANCE (MPa)		60.0	87.2	87.2	98.1	103.6	119.9	136.3	163.5	
	INTERNAL YIELD PRESSURE (MPa)		57.4	83.5	83.5	94.0	99.2	114.9	130.5	156.6	
	MAXIMUM LOAD OF REG. COUPLING FACE (kN)		853	1240	1240	1396	1473	1706	1938	2326	
	MAXIMUM LOAD OF S.C. COUPLING FACE (kN)		428	622	622	700	738	855	972	1166	
	PARTING LOAD (kN)										
	REGULAR COUPLING O.D.		2405	2531	2405	2531	2658	3164	3417	4050	
	SPECIAL CLEARANCE COUPLING O.D.		1707	1797	1707	1797	1886	2246	2425	2875	
			OUTSIDE DIA.(mm)	INSIDE DIA.(mm)	WEIGHT (kg)		JOINT EFFICIENCY (%)		30' JOINT MUD DISPLACEMENT (m³)		
	REGULAR COUPLING		W	154.30	122.76	9.64		80		0.04516	
	SPECIAL CLEARANCE COUPLING		Wc	149.61	122.76	7.05		57		0.04483	
LENGTH OF COUPLING (mm)		NL	294.46								
MAKE UP LOSS (mm)		ML	123.19								

The above information is for reference only. The information is subject to change or modification without notice. Please contact HSC for the latest information