

TECHNICAL INFORMATION

CASING

SIZE:	7 5/8 "
NOMINAL WEIGHT:	39.00 lb/ft
WALL THICKNESS:	0.500 "
THREADS PER INCH:	5

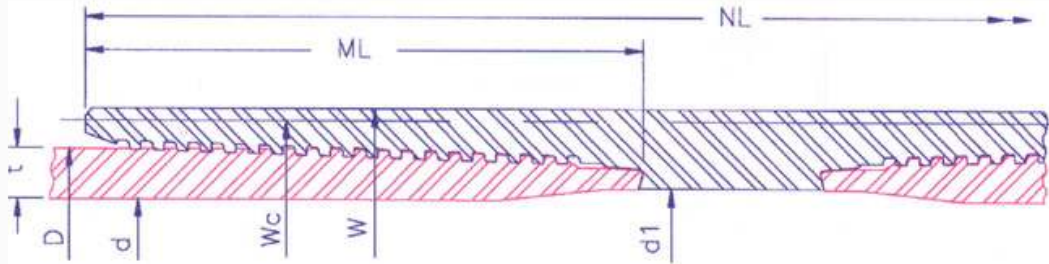

P I P E B O D Y	OUTSIDE DIA.(in)D	7.625	INSIDE DIA.(in) d		6.625	DRIFT DIA. (in)		6.500	PLAIN END WT (lb/ft)		38.05
	GRADE		K55	N80	L80	C90	C95	P110	Q125	150	
	COLLAPSE RESISTANCE (psi)		6610	8820	8820	9620	10000	11080	12060	13440	
	INTERNAL YIELD PRESSURE (psi)		6310	9180	9180	10330	10900	12620	14340	17210	
	BODY YIELD STRENGTH (kips)		616	895	895	1007	1063	1231	1399	1679	
	ULTIMATE STRENGTH (kips)		1063	1119	1063	1119	1175	1399	1511	1791	
	YIELD TORQUE (ft/lb)		99100	144100	144100	162100	171100	198100	225200	270200	

RECOMMENDED MAKEUP TORQUE USING A THREAD COMPOUND WITH FRICTION CORRECTION FACTOR OF 1.0										
M A K E U P	REGULAR	MINIMUM (ft/lb)	9850	11100	11100	12100	12100	12700	13700	14400
		OPTIMUM (ft/lb)	10850	12300	12300	13400	13400	14100	15200	15900
		MAXIMUM (ft/lb)	11850	13500	13500	14700	14700	15500	16700	17400
	SPECIAL CLEARANCE	MINIMUM (ft/lb)	9850	11100	11100	12100	12100	12700	13700	14400
		OPTIMUM (ft/lb)	10850	12300	12300	13400	13400	14100	15200	15900
		MAXIMUM (ft/lb)	11850	13500	13500	14700	14700	15500	16700	17400

C O N N E C T I O N	COLLAPSE RESISTANCE (psi)		6610	8820	8820	9620	10000	11080	12060	13440	
	INTERNAL YIELD PRESSURE (psi)		6310	9180	9180	10330	10900	12620	14340	17210	
	MAXIMUM LOAD OF REG. COUPLING FACE (kips)		493	717	717	807	852	986	1121	1345	
	MAXIMUM LOAD OF S.C. COUPLING FACE (kips)		215	313	313	352	372	431	489	587	
	PARTING LOAD (kips)										
	REGULAR COUPLING O.D.		864	981	945	1013	1065	1258	1379	1640	
	SPECIAL CLEARANCE COUPLING O.D.		713	750	713	750	788	938	1013	1201	
			OUTSIDE DIA.(in)	INSIDE DIA.(in)	WEIGHT (lb)		JOINT EFFICIENCY (%)		30' JOINT MUD DISPLACEMENT (in ²)		
	REGULAR COUPLING		W	8.528	6.939	63.56		116		4159	
	SPECIAL CLEARANCE COUPLING		Wc	8.142	6.939	45.38		71		4095	
	LENGTH OF COUPLING (in)		NL	12.695		The above information is for reference only. The information is subject to change or modification without notice. Please contact HSC for the latest information					
MAKE UP LOSS (in)		ML	5.406								