

TECHNICAL INFORMATION

CASING

| | |
|-------------------|------------|
| SIZE: | 193.68 mm |
| NOMINAL WEIGHT: | 50.15 kg/m |
| WALL THICKNESS: | 10.92 mm |
| THREADS PER INCH: | 5 |

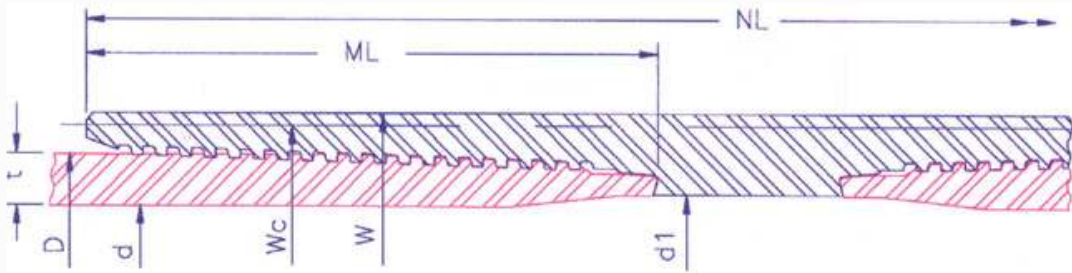

| | | | | | | | | | | |
|---|-------------------------------|--------|-------------------|--------|-----------------|--------|---------------------|--------|--------|--------|
| P I P E B O D Y | OUTSIDE DIA.(mm)D | 193.68 | INSIDE DIA.(mm) d | 171.83 | DRIFT DIA. (mm) | 168.66 | PLAIN END WT (kg/m) | | | 49.17 |
| | GRADE | | K55 | N80 | L80 | C90 | C95 | P110 | Q125 | 150 |
| | COLLAPSE RESISTANCE (MPa) | | 35.1 | 45.2 | 45.2 | 48.6 | 50.2 | 54.3 | 57.5 | 61.0 |
| | INTERNAL YIELD PRESSURE (MPa) | | 37.4 | 54.4 | 54.4 | 61.2 | 64.6 | 74.8 | 85.1 | 102.1 |
| | BODY YIELD STRENGTH (kN) | | 2378 | 3459 | 3459 | 3891 | 4107 | 4756 | 5404 | 6485 |
| | ULTIMATE STRENGTH (kN) | | 4107 | 4323 | 4107 | 4323 | 4540 | 5404 | 5837 | 6918 |
| | YIELD TORQUE (Nm) | | 118800 | 172800 | 172800 | 194400 | 205200 | 237600 | 270000 | 324000 |

| | | | | | | | | | | |
|---|--|--------------|-------|-------|-------|-------|-------|-------|-------|-------|
| M A K E U P | RECOMMENDED MAKEUP TORQUE USING A THREAD COMPOUND WITH FRICTION CORRECTION FACTOR OF 1.0 | | | | | | | | | |
| | REGULAR | MINIMUM (Nm) | 12410 | 14170 | 14170 | 15050 | 15050 | 16410 | 17220 | 19520 |
| | | OPTIMUM (Nm) | 13760 | 15660 | 15660 | 16680 | 16680 | 18170 | 19120 | 21560 |
| | | MAXIMUM (Nm) | 15120 | 17150 | 17150 | 18300 | 18300 | 19930 | 21020 | 23590 |
| | SPECIAL CLEARANCE | MINIMUM (Nm) | 12410 | 14170 | 14170 | 15050 | 15050 | 16410 | 17220 | 19520 |
| | | OPTIMUM (Nm) | 13760 | 15660 | 15660 | 16680 | 16680 | 18170 | 19120 | 21560 |
| MAXIMUM (Nm) | | 15120 | 17150 | 17150 | 18300 | 18300 | 19930 | 21020 | 23590 | |

| | | | | | | | | | | |
|--|---|----|------------------|-----------------|-------------|-------|----------------------|------|---------------------------------|---------|
| C O N N E C T I O N | COLLAPSE RESISTANCE (MPa) | | 35.1 | 45.2 | 45.2 | 48.6 | 50.2 | 54.3 | 57.5 | 61.0 |
| | INTERNAL YIELD PRESSURE (MPa) | | 37.4 | 54.4 | 54.4 | 61.2 | 64.6 | 74.8 | 85.1 | 102.1 |
| | MAXIMUM LOAD OF REG. COUPLING FACE (kN) | | 2194 | 3191 | 3191 | 3590 | 3790 | 4388 | 4986 | 5983 |
| | MAXIMUM LOAD OF S.C. COUPLING FACE (kN) | | 958 | 1393 | 1393 | 1567 | 1654 | 1915 | 2176 | 2611 |
| | PARTING LOAD (kN) | | | | | | | | | |
| | REGULAR COUPLING O.D. | | 3339 | 3789 | 3649 | 3913 | 4115 | 4861 | 5326 | 6336 |
| | SPECIAL CLEARANCE COUPLING O.D. | | 3171 | 3338 | 3171 | 3338 | 3505 | 4172 | 4506 | 5341 |
| | | | OUTSIDE DIA.(mm) | INSIDE DIA.(mm) | WEIGHT (kg) | | JOINT EFFICIENCY (%) | | 30' JOINT MUD DISPLACEMENT (m³) | |
| | REGULAR COUPLING | | W | 216.61 | 176.25 | 28.83 | | 133 | | 0.05960 |
| | SPECIAL CLEARANCE COUPLING | | Wc | 206.81 | 176.25 | 20.59 | | 81 | | 0.05855 |
| LENGTH OF COUPLING (mm) | | NL | 322.45 | | | | | | | |
| MAKE UP LOSS (mm) | | ML | 137.31 | | | | | | | |

The above information is for reference only. The information is subject to change or modification without notice. Please contact HSC for the latest information