

TECHNICAL INFORMATION

CASING

SIZE:	177.80 mm
NOMINAL WEIGHT:	52.09 kg/m
WALL THICKNESS:	12.65 mm
THREADS PER INCH:	5

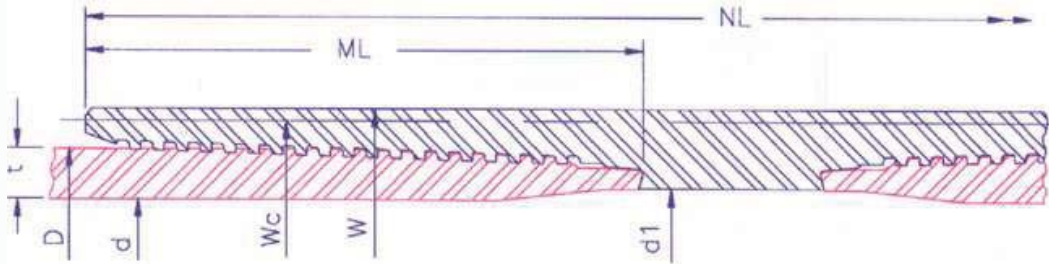

P I P E B O D Y	OUTSIDE DIA.(mm)D	177.80	INSIDE DIA.(mm) d	152.50	DRIFT DIA. (mm)			PLAIN END WT (kg/m)		51.46
	GRADE		K55	N80	L80	C90	C95	P110	Q125	150
	COLLAPSE RESISTANCE (MPa)		50.1	70.2	70.2	77.0	80.3	89.8	98.7	111.9
	INTERNAL YIELD PRESSURE (MPa)		47.2	68.7	68.7	77.3	81.5	94.4	107.3	128.8
	BODY YIELD STRENGTH (kN)		2489	3620	3620	4072	4299	4977	5656	6787
	ULTIMATE STRENGTH (kN)		4299	4525	4299	4525	4751	5656	6109	7240
	YIELD TORQUE (Nm)		110850	161240	161240	181400	191480	221710	251940	302330

M A K E U P	RECOMMENDED MAKEUP TORQUE USING A THREAD COMPOUND WITH FRICTION CORRECTION FACTOR OF 1.0									
	REGULAR	MINIMUM (Nm)	11470	12880	12880	13690	13690	14710	15520	16880
		OPTIMUM (Nm)	12740	14240	14240	15190	15190	16200	17150	18640
		MAXIMUM (Nm)	14020	15590	15590	16680	16680	17690	18780	20410
	SPECIAL CLEARANCE	MINIMUM (Nm)	11470	12880	12880	13690	13690	14710	15520	16880
		OPTIMUM (Nm)	12740	14240	14240	15190	15190	16200	17150	18640
MAXIMUM (Nm)		14020	15590	15590	16680	16680	17690	18780	20410	

C O N N E C T I O N	COLLAPSE RESISTANCE (MPa)		50.1	70.2	70.2	77.0	80.3	89.8	98.7	111.9	
	INTERNAL YIELD PRESSURE (MPa)		47.2	68.7	68.7	77.3	81.5	94.4	107.3	128.8	
	MAXIMUM LOAD OF REG. COUPLING FACE (kN)		1384	2013	2013	2264	2390	2767	3145	3774	
	MAXIMUM LOAD OF S.C. COUPLING FACE (kN)		541	787	787	885	934	1082	1229	1475	
			PARTING LOAD (kN)								
	REGULAR COUPLING O.D.		3546	3839	3647	3839	4031	4799	5183	6142	
	SPECIAL CLEARANCE COUPLING O.D.		2264	2383	2264	2383	2503	2979	3218	3814	
			OUTSIDE DIA.(mm)	INSIDE DIA.(mm)	WEIGHT (kg)		JOINT EFFICIENCY (%)		30' JOINT MUD DISPLACEMENT (m³)		
	REGULAR COUPLING	W	195.10	161.04	15.03		89		0.06134		
	SPECIAL CLEARANCE COUPLING	Wc	187.71	161.04	9.57		55		0.06064		
LENGTH OF COUPLING (mm)	NL	313.46									
MAKE UP LOSS (mm)	ML	132.79									

The above information is for reference only. The information is subject to change or modification without notice. Please contact HSC for the latest information