

# TECHNICAL INFORMATION

# CASING

SIZE:	8 5/8 "
NOMINAL WEIGHT:	28.00 lb/ft
WALL THICKNESS:	0.304 "
THREADS PER INCH:	5

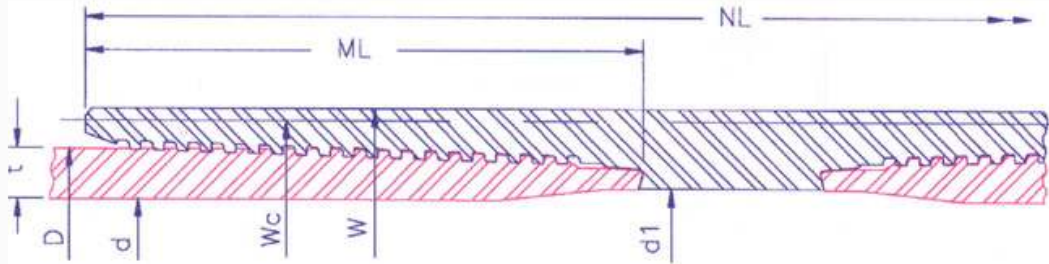

<b>P I P E  B O D Y</b>	OUTSIDE DIA.(in)D	8.625	INSIDE DIA.(in) d	8.017	DRIFT DIA. (in)			PLAIN END WT (lb/ft)		
	GRADE	K55	N80	L80	C90	C95	P110	Q125	150	
	COLLAPSE RESISTANCE (psi)	1880	2160	2160	2200	2210	2210	2210	2210	
	INTERNAL YIELD PRESSURE (psi)	3390	4930	4930	5550	5860	6780	7710	9250	
	BODY YIELD STRENGTH (kips)	437	636	636	715	755	874	993	1192	
	ULTIMATE STRENGTH (kips)	755	795	755	795	834	993	1073	1272	
	YIELD TORQUE (ft/lb)	84500	122900	122900	138300	146000	169000	192100	230500	

<b>M A K E  U P</b>	RECOMMENDED MAKEUP TORQUE USING A THREAD COMPOUND WITH FRICTION CORRECTION FACTOR OF 1.0									
	REGULAR	MINIMUM (ft/lb)	6840	7830	7830	8460	8460	9150	9850	10850
		OPTIMUM (ft/lb)	7590	8700	8700	9400	9400	10150	10850	11950
		MAXIMUM (ft/lb)	8340	9570	9570	10340	10340	11150	11850	13050
	SPECIAL CLEARANCE	MINIMUM (ft/lb)	6840	7830	7830	8460	8460	9150	9850	10850
		OPTIMUM (ft/lb)	7590	8700	8700	9400	9400	10150	10850	11950
MAXIMUM (ft/lb)		8340	9570	9570	10340	10340	11150	11850	13050	

<b>C O N N E C T I O N</b>	COLLAPSE RESISTANCE (psi)	1880	2160	2160	2200	2210	2210	2210	2210	
	INTERNAL YIELD PRESSURE (psi)	3390	4930	4930	5550	5860	6780	7710	9250	
	MAXIMUM LOAD OF REG. COUPLING FACE (kips)	653	950	950	1069	1128	1306	1484	1781	
	MAXIMUM LOAD OF S.C. COUPLING FACE (kips)	241	350	350	394	416	481	547	656	
	PARTING LOAD (kips)									
	REGULAR COUPLING O.D.	599	688	664	714	751	886	973	1158	
	SPECIAL CLEARANCE COUPLING O.D.	599	688	664	714	751	886	973	1158	
		OUTSIDE DIA.(in)	INSIDE DIA.(in)	WEIGHT (lb)		JOINT EFFICIENCY (%)		30' JOINT MUD DISPLACEMENT (in <sup>3</sup> )		
	REGULAR COUPLING	W	9.650	8.037	60.96		207		3051	
	SPECIAL CLEARANCE COUPLING	Wc	9.142	8.037	33.41		112		2953	
LENGTH OF COUPLING (in)	NL	12.971								
MAKE UP LOSS (in)	ML	5.545								

The above information is for reference only. The information is subject to change or modification without notice. Please contact HSC for the latest information