

TECHNICAL INFORMATION

CASING

SIZE:	8 5/8 "
NOMINAL WEIGHT:	32.00 lb/ft
WALL THICKNESS:	0.352 "
THREADS PER INCH:	5

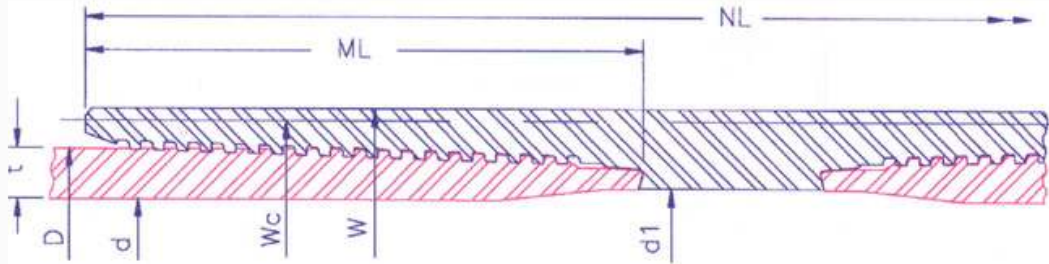

P I P E B O D Y	OUTSIDE DIA.(in)D	8.625	INSIDE DIA.(in) d		7.921	DRIFT DIA. (in)			7.796	PLAIN END WT (lb/ft)		31.10
	GRADE		K55	N80	L80	C90	C95	P110	Q125	150		
	COLLAPSE RESISTANCE (psi)		2530	3050	3050	3210	3280	3420	3470	3470		
	INTERNAL YIELD PRESSURE (psi)		3930	5710	5710	6430	6780	7860	8930	10710		
	BODY YIELD STRENGTH (kips)		503	732	732	823	869	1006	1144	1372		
	ULTIMATE STRENGTH (kips)		869	915	869	915	961	1144	1235	1464		
	YIELD TORQUE (ft/lb)		96200	140000	140000	157500	166200	192500	218700	262400		

M A K E U P	RECOMMENDED MAKEUP TORQUE USING A THREAD COMPOUND WITH FRICTION CORRECTION FACTOR OF 1.0										
	REGULAR	MINIMUM (ft/lb)	7470	8460	8460	9150	9150	9850	10450	11700	
		OPTIMUM (ft/lb)	8300	9400	9400	10150	10150	10850	11550	13000	
		MAXIMUM (ft/lb)	9130	10340	10340	11150	11150	11850	12650	14300	
	SPECIAL CLEARANCE	MINIMUM (ft/lb)	7470	8460	8460	9150	9150	9850	10450	11700	
		OPTIMUM (ft/lb)	8300	9400	9400	10150	10150	10850	11550	13000	
MAXIMUM (ft/lb)		9130	10340	10340	11150	11150	11850	12650	14300		

C O N N E C T I O N	COLLAPSE RESISTANCE (psi)		2530	3050	3050	3210	3280	3420	3470	3470	
	INTERNAL YIELD PRESSURE (psi)		3930	5710	5710	6430	6780	7860	8930	10710	
	MAXIMUM LOAD OF REG. COUPLING FACE (kips)		653	950	950	1069	1128	1306	1484	1781	
	MAXIMUM LOAD OF S.C. COUPLING FACE (kips)		241	350	350	394	416	481	547	656	
	PARTING LOAD (kips)										
	REGULAR COUPLING O.D.		690	792	764	822	864	1020	1120	1333	
	SPECIAL CLEARANCE COUPLING O.D.		690	792	764	822	864	1020	1120	1333	
			OUTSIDE DIA.(in)	INSIDE DIA.(in)	WEIGHT (lb)		JOINT EFFICIENCY (%)		30' JOINT MUD DISPLACEMENT (in ²)		
	REGULAR COUPLING		W	9.650	8.037	60.96		180		3479	
	SPECIAL CLEARANCE COUPLING		Wc	9.142	8.037	33.41		98		3381	
LENGTH OF COUPLING (in)		NL	12.971		The above information is for reference only. The information is subject to change or modification without notice. Please contact HSC for the latest information						
MAKE UP LOSS (in)		ML	5.545								