

TECHNICAL INFORMATION

CASING

SIZE:	219.08 mm
NOMINAL WEIGHT:	65.48 kg/m
WALL THICKNESS:	12.70 mm
THREADS PER INCH:	5

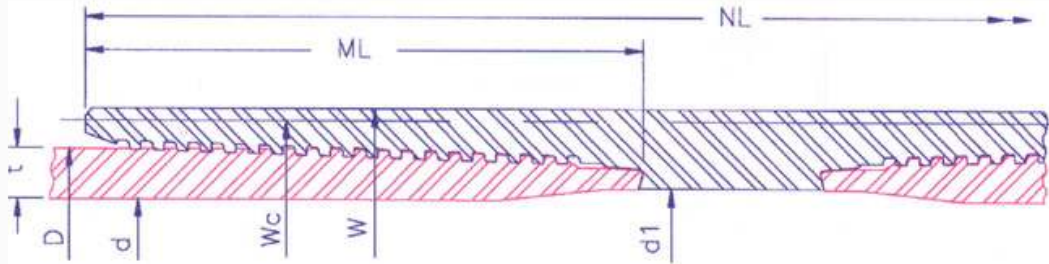

PIPE BODY	OUTSIDE DIA.(mm)D	219.08	INSIDE DIA.(mm) d	193.68	DRIFT DIA. (mm)	190.50	PLAIN END WT (kg/m)			64.57
	GRADE	K55		N80	L80	C90	C95	P110	Q125	150
	COLLAPSE RESISTANCE (MPa)	36.9		47.9	47.9	51.7	53.4	58.1	61.9	66.4
	INTERNAL YIELD PRESSURE (MPa)	38.5		56.0	56.0	63.0	66.4	76.9	87.4	104.9
	BODY YIELD STRENGTH (kN)	3122		4542	4542	5109	5393	6245	7096	8516
	ULTIMATE STRENGTH (kN)	5393		5677	5393	5677	5961	7096	7664	9083
	YIELD TORQUE (Nm)	175900		255850	255850	287840	303830	351800	399770	479730

RECOMMENDED MAKEUP TORQUE USING A THREAD COMPOUND WITH FRICTION CORRECTION FACTOR OF 1.0										
MAKEUP	REGULAR	MINIMUM (Nm)	14170	15860	15860	17220	17220	18570	19520	19520
		OPTIMUM (Nm)	15660	17630	17630	19120	19120	20610	21560	21560
		MAXIMUM (Nm)	17150	19390	19390	21020	21020	22640	23590	23590
	SPECIAL CLEARANCE	MINIMUM (Nm)	14170	15860	15860	17220	17220	18570	19520	19520
		OPTIMUM (Nm)	15660	17630	17630	19120	19120	20610	21560	21560
		MAXIMUM (Nm)	17150	19390	19390	21020	21020	22640	23590	23590

CONNECTION	COLLAPSE RESISTANCE (MPa)		36.9	47.9	47.9	51.7	53.4	58.1	61.9	66.4
	INTERNAL YIELD PRESSURE (MPa)		38.5	56.0	56.0	63.0	66.4	76.9	87.4	104.9
	MAXIMUM LOAD OF REG. COUPLING FACE (kN)		2905	4225	4225	4754	5018	5810	6602	7923
	MAXIMUM LOAD OF S.C. COUPLING FACE (kN)		1071	1557	1557	1752	1849	2141	2433	2920
	PARTING LOAD (kN)									
	REGULAR COUPLING O.D.		4283	4915	4743	5099	5363	6328	6949	8269
	SPECIAL CLEARANCE COUPLING O.D.		3587	3776	3587	3776	3965	4720	5098	6042
			OUTSIDE DIA.(mm)	INSIDE DIA.(mm)	WEIGHT (kg)		JOINT EFFICIENCY (%)		30' JOINT MUD DISPLACEMENT (m³)	
	REGULAR COUPLING		W	245.11	202.74	27.83		129		0.07807
	SPECIAL CLEARANCE COUPLING		Wc	232.21	202.74	15.33		70		0.07647
LENGTH OF COUPLING (mm)		NL	329.46							
MAKE UP LOSS (mm)		ML	140.84							

The above information is for reference only. The information is subject to change or modification without notice. Please contact HSC for the latest information