

TECHNICAL INFORMATION

CASING

SIZE:	219.08 mm
NOMINAL WEIGHT:	72.92 kg/m
WALL THICKNESS:	14.15 mm
THREADS PER INCH:	5

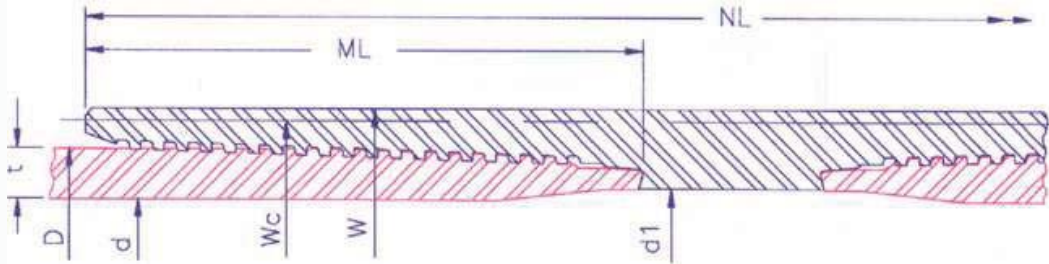

P I P E B O D Y	OUTSIDE DIA.(mm)D	219.08	INSIDE DIA.(mm) d	190.78	DRIFT DIA. (mm)					187.60	PLAIN END WT (kg/m)	71.42
	GRADE	K55		N80	L80	C90	C95	P110	Q125	150		
	COLLAPSE RESISTANCE (MPa)	44.4		59.1	59.1	64.4	66.9	74.0	80.4	89.2		
	INTERNAL YIELD PRESSURE (MPa)	42.9		62.3	62.3	70.1	74.0	85.7	97.4	116.9		
	BODY YIELD STRENGTH (kN)	3454		5024	5024	5652	5966	6908	7850	9420		
	ULTIMATE STRENGTH (kN)	5966		6280	5966	6280	6594	7850	8478	10048		
	YIELD TORQUE (Nm)	192040		279340	279340	314250	331710	384090	436460	523760		

RECOMMENDED MAKEUP TORQUE USING A THREAD COMPOUND WITH FRICTION CORRECTION FACTOR OF 1.0										
M A K E U P	REGULAR	MINIMUM (Nm)	15050	16880	16880	18570	18570	19520	19520	19520
		OPTIMUM (Nm)	16680	18640	18640	20610	20610	21560	21560	21560
		MAXIMUM (Nm)	18300	20410	20410	22640	22640	23590	23590	23590
	SPECIAL CLEARANCE	MINIMUM (Nm)	15050	16880	16880	18570	18570	19520	19520	19520
		OPTIMUM (Nm)	16680	18640	18640	20610	20610	21560	21560	21560
		MAXIMUM (Nm)	18300	20410	20410	22640	22640	23590	23590	23590

C O N N E C T I O N	COLLAPSE RESISTANCE (MPa)		44.4	59.1	59.1	64.4	66.9	74.0	80.4	89.2	
	INTERNAL YIELD PRESSURE (MPa)		42.9	62.3	62.3	70.1	74.0	85.7	97.4	116.9	
	MAXIMUM LOAD OF REG. COUPLING FACE (kN)		2905	4225	4225	4754	5018	5810	6602	7923	
	MAXIMUM LOAD OF S.C. COUPLING FACE (kN)		1071	1557	1557	1752	1849	2141	2433	2920	
	PARTING LOAD (kN)										
	REGULAR COUPLING O.D.		4737	5437	5247	5641	5933	7000	7686	9148	
	SPECIAL CLEARANCE COUPLING O.D.		3587	3776	3587	3776	3965	4720	5098	6042	
			OUTSIDE DIA.(mm)	INSIDE DIA.(mm)	WEIGHT (kg)		JOINT EFFICIENCY (%)		30' JOINT MUD DISPLACEMENT (m³)		
	REGULAR COUPLING		W	245.11	202.74	27.83		116		0.08590	
	SPECIAL CLEARANCE COUPLING		Wc	232.21	202.74	15.33		63		0.08431	
	LENGTH OF COUPLING (mm)		NL	329.46							
MAKE UP LOSS (mm)		ML	140.84								

The above information is for reference only. The information is subject to change or modification without notice. Please contact HSC for the latest information