

TECHNICAL INFORMATION

CASING

SIZE:	9 5/8 "
NOMINAL WEIGHT:	47.00 lb/ft
WALL THICKNESS:	0.472 "
THREADS PER INCH:	5

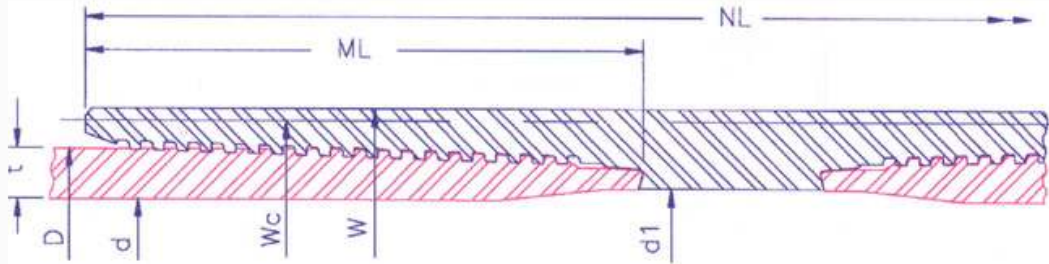

P I P E B O D Y	OUTSIDE DIA.(in)D	9.625	INSIDE DIA.(in) d	8.681	DRIFT DIA. (in)					8.525	PLAIN END WT (lb/ft)		46.14
	GRADE			K55	N80	L80	C90	C95	P110	Q125	150		
	COLLAPSE RESISTANCE (psi)			3890	4750	4750	4990	5090	5300	5630	6000		
	INTERNAL YIELD PRESSURE (psi)			4720	6870	6870	7720	8150	9440	10730	12870		
	BODY YIELD STRENGTH (kips)			746	1086	1086	1222	1289	1493	1697	2036		
	ULTIMATE STRENGTH (kips)			1289	1357	1289	1357	1425	1697	1832	2172		
	YIELD TORQUE (ft/lb)			156700	228000	228000	256500	270700	313400	356200	427400		

M A K E U P	RECOMMENDED MAKEUP TORQUE USING A THREAD COMPOUND WITH FRICTION CORRECTION FACTOR OF 1.0										
	REGULAR	MINIMUM (ft/lb)	11100	13050	13050	14400	14400	14400	14400	14400	14400
		OPTIMUM (ft/lb)	12300	14450	14450	15900	15900	15900	15900	15900	15900
		MAXIMUM (ft/lb)	13500	15850	15850	17400	17400	17400	17400	17400	17400
	SPECIAL CLEARANCE	MINIMUM (ft/lb)	11100	13050	13050	14400	14400	14400	14400	14400	14400
		OPTIMUM (ft/lb)	12300	14450	14450	15900	15900	15900	15900	15900	15900
MAXIMUM (ft/lb)		13500	15850	15850	17400	17400	17400	17400	17400	17400	

C O N N E C T I O N	COLLAPSE RESISTANCE (psi)			3890	4750	4750	4990	5090	5300	5630	6000
	INTERNAL YIELD PRESSURE (psi)			4720	6870	6870	7720	8150	9440	10730	12870
	MAXIMUM LOAD OF REG. COUPLING FACE (kips)			723	1051	1051	1183	1249	1446	1643	1971
	MAXIMUM LOAD OF S.C. COUPLING FACE (kips)			267	388	388	436	461	533	606	727
	PARTING LOAD (kips)										
	REGULAR COUPLING O.D.			999	1161	1122	1210	1273	1500	1650	1965
	SPECIAL CLEARANCE COUPLING O.D.			898	945	898	945	992	1181	1276	1512
				OUTSIDE DIA.(in)	INSIDE DIA.(in)	WEIGHT (lb)		JOINT EFFICIENCY (%)		30' JOINT MUD DISPLACEMENT (in ²)	
	REGULAR COUPLING			W	10.650	8.947	68.40		134		5081
	SPECIAL CLEARANCE COUPLING			Wc	10.142	8.947	37.91		73		4974
LENGTH OF COUPLING (in)			NL	12.971							
MAKE UP LOSS (in)			ML	5.545							

The above information is for reference only. The information is subject to change or modification without notice. Please contact HSC for the latest information