

# TECHNICAL INFORMATION

# CASING

SIZE:	11 3/4 "
NOMINAL WEIGHT:	65.00 lb/ft
WALL THICKNESS:	0.534 "
THREADS PER INCH:	5

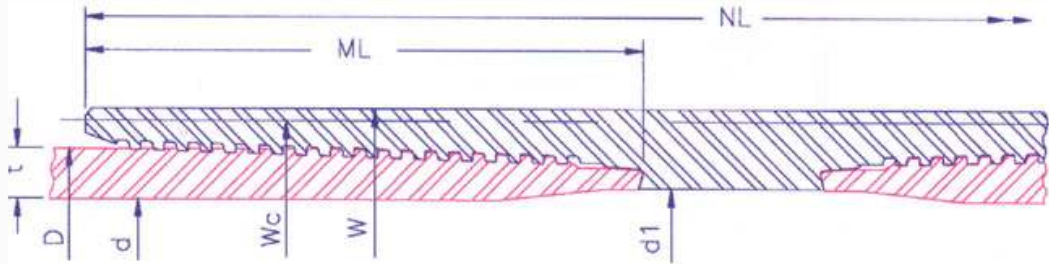

<b>P I P E  B O D Y</b>	OUTSIDE DIA.(in)D	11.750	INSIDE DIA.(in) d		10.682	DRIFT DIA. (in)			10.526	PLAIN END WT (lb/ft)		63.97
	GRADE		K55	N80	L80	C90	C95	P110	Q125	150		
	COLLAPSE RESISTANCE (psi)		3300	3870	3870	4050	4170	4470	4680	4830		
	INTERNAL YIELD PRESSURE (psi)		4370	6360	6360	7160	7560	8750	9940	11930		
	BODY YIELD STRENGTH (kips)		1035	1505	1505	1693	1788	2070	2352	2822		
	ULTIMATE STRENGTH (kips)		1788	1882	1788	1882	1976	2352	2540	3011		
	YIELD TORQUE (ft/lb)		267100	388600	388600	437100	461400	534300	607100	728600		

RECOMMENDED MAKEUP TORQUE USING A THREAD COMPOUND WITH FRICTION CORRECTION FACTOR OF 1.0											
<b>M A K E  U P</b>	REGULAR	MINIMUM (ft/lb)	14400	14400	14400	14400	14400	14400	14400	14400	14400
		OPTIMUM (ft/lb)	15900	15900	15900	15900	15900	15900	15900	15900	15900
		MAXIMUM (ft/lb)	17400	17400	17400	17400	17400	17400	17400	17400	17400
	SPECIAL CLEARANCE	MINIMUM (ft/lb)	14400	14400	14400	14400	14400	14400	14400	14400	14400
		OPTIMUM (ft/lb)	15900	15900	15900	15900	15900	15900	15900	15900	15900
		MAXIMUM (ft/lb)	17400	17400	17400	17400	17400	17400	17400	17400	17400

<b>C O N N E C T I O N</b>	COLLAPSE RESISTANCE (psi)		3300	3870	3870	4050	4170	4470	4680	4830	
	INTERNAL YIELD PRESSURE (psi)		4370	6360	6360	7160	7560	8750	9940	11930	
	MAXIMUM LOAD OF REG. COUPLING FACE (kips)		871	1266	1266	1425	1504	1741	1979	2374	
	MAXIMUM LOAD OF S.C. COUPLING FACE (kips)		325	473	473	533	562	651	740	888	
	<b>PARTING LOAD (kips)</b>										
	REGULAR COUPLING O.D.		1313	1566	1521	1650	1736	2041	2256	2689	
	SPECIAL CLEARANCE COUPLING O.D.		1099	1157	1099	1157	1215	1446	1562	1851	
			OUTSIDE DIA.(in)	INSIDE DIA.(in)	WEIGHT (lb)		JOINT EFFICIENCY (%)		30' JOINT MUD DISPLACEMENT (in <sup>2</sup> )		
	REGULAR COUPLING		W	12.772	11.023	84.06		117		7003	
	SPECIAL CLEARANCE COUPLING		Wc	12.268	11.023	47.30		65		6873	
	LENGTH OF COUPLING (in)		NL	13.089							
MAKE UP LOSS (in)		ML	5.589								

The above information is for reference only. The information is subject to change or modification without notice. Please contact HSC for the latest information