

TECHNICAL INFORMATION

CASING

SIZE:	13 3/8 "
NOMINAL WEIGHT:	54.50 lb/ft
WALL THICKNESS:	0.380 "
THREADS PER INCH:	5

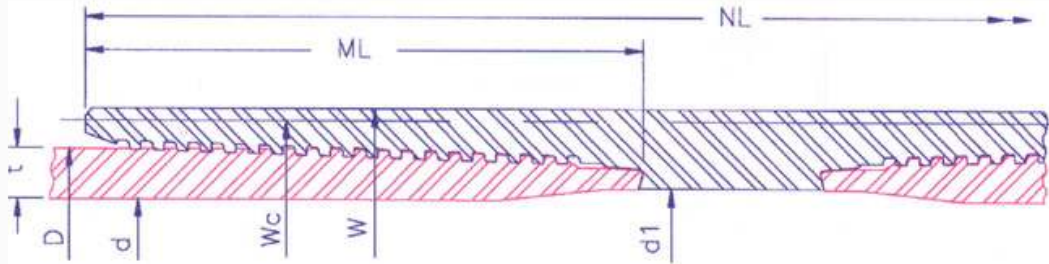

P I P E B O D Y	OUTSIDE DIA.(in)D	13.375	INSIDE DIA.(in) d		12.615	DRIFT DIA. (in)			12.459	PLAIN END WT (lb/ft)		52.74
	GRADE		K55	N80	L80	C90	C95	P110	Q125	150		
	COLLAPSE RESISTANCE (psi)		1130	1140	1140	1140	1140	1140	1140	1140	1140	
	INTERNAL YIELD PRESSURE (psi)		2730	3980	3980	4470	4720	5470	6210	7460		
	BODY YIELD STRENGTH (kips)		853	1241	1241	1396	1474	1706	1939	2327		
	ULTIMATE STRENGTH (kips)		1474	1551	1474	1551	1629	1939	2094	2482		
	YIELD TORQUE (ft/lb)		259400	377300	377300	424400	448000	518800	589500	707400		

M A K E U P	RECOMMENDED MAKEUP TORQUE USING A THREAD COMPOUND WITH FRICTION CORRECTION FACTOR OF 1.0										
	REGULAR	MINIMUM (ft/lb)	10450	13050	13050	14400	14400	14400	14400	14400	14400
		OPTIMUM (ft/lb)	11550	14450	14450	15900	15900	15900	15900	15900	15900
		MAXIMUM (ft/lb)	12650	15850	15850	17400	17400	17400	17400	17400	17400
	SPECIAL CLEARANCE	MINIMUM (ft/lb)	10450	13050	13050	14400	14400	14400	14400	14400	14400
		OPTIMUM (ft/lb)	11550	14450	14450	15900	15900	15900	15900	15900	15900
MAXIMUM (ft/lb)		12650	15850	15850	17400	17400	17400	17400	17400	17400	

C O N N E C T I O N	COLLAPSE RESISTANCE (psi)		1130	1140	1140	1140	1140	1140	1140	1140	
	INTERNAL YIELD PRESSURE (psi)		2730	3980	3980	4470	4720	5470	6210	7460	
	MAXIMUM LOAD OF REG. COUPLING FACE (kips)		986	1435	1435	1614	1704	1973	2241	2690	
	MAXIMUM LOAD OF S.C. COUPLING FACE (kips)		651	947	947	1065	1125	1302	1480	1776	
	PARTING LOAD (kips)										
	REGULAR COUPLING O.D.		1038	1265	1233	1343	1414	1659	1840	2195	
	SPECIAL CLEARANCE COUPLING O.D.		1038	1265	1233	1343	1414	1659	1840	2195	
			OUTSIDE DIA.(in)	INSIDE DIA.(in)	WEIGHT (lb)		JOINT EFFICIENCY (%)		30' JOINT MUD DISPLACEMENT (in ²)		
	REGULAR COUPLING		W	14.398	12.758	94.00		162		5866	
	SPECIAL CLEARANCE COUPLING		Wc	14.126	12.758	71.41		123		5786	
LENGTH OF COUPLING (in)		NL	13.089								
MAKE UP LOSS (in)		ML	5.642								

The above information is for reference only. The information is subject to change or modification without notice. Please contact HSC for the latest information