

# TECHNICAL INFORMATION

# CASING

SIZE:	5 1/2 "
NOMINAL WEIGHT:	20.00 lb/ft
WALL THICKNESS:	0.361 "
THREADS PER INCH:	5

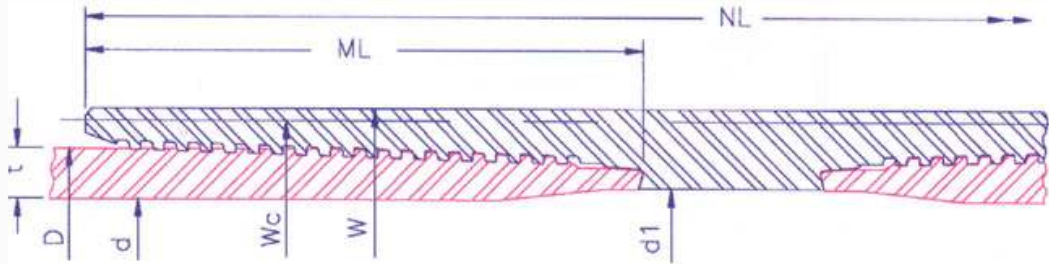

<b>P I P E  B O D Y</b>	OUTSIDE DIA.(in)D	5.500	INSIDE DIA.(in) d	4.778	DRIFT DIA. (in)					4.653	PLAIN END WT (lb/ft)		19.81
	GRADE		K55	N80	L80	C90	C95	P110	Q125	150			
	COLLAPSE RESISTANCE (psi)		6620	8830	8830	9630	10020	11100	12080	13470			
	INTERNAL YIELD PRESSURE (psi)		6320	9190	9190	10340	10910	12640	14360	17230			
	BODY YIELD STRENGTH (kips)		321	466	466	525	554	641	729	874			
	ULTIMATE STRENGTH (kips)		554	583	554	583	612	729	787	933			
	YIELD TORQUE (ft/lb)		37200	54100	54100	60900	64300	74400	84600	101500			

<b>M A K E  U P</b>	RECOMMENDED MAKEUP TORQUE USING A THREAD COMPOUND WITH FRICTION CORRECTION FACTOR OF 1.0											
	REGULAR	MINIMUM (ft/lb)	5340	5860	5860	6120	6120	6450	6840	7170		
		OPTIMUM (ft/lb)	5930	6510	6510	6800	6800	7160	7590	7960		
		MAXIMUM (ft/lb)	6520	7160	7160	7480	7480	7870	8340	8750		
	SPECIAL CLEARANCE	MINIMUM (ft/lb)	5340	5860	5860	6120	6120	6450	6840	7170		
		OPTIMUM (ft/lb)	5930	6510	6510	6800	6800	7160	7590	7960		
MAXIMUM (ft/lb)		6520	7160	7160	7480	7480	7870	8340	8750			

<b>C O N N E C T I O N</b>	COLLAPSE RESISTANCE (psi)		6620	8830	8830	9630	10020	11100	12080	13470	
	INTERNAL YIELD PRESSURE (psi)		6320	9190	9190	10340	10910	12640	14360	17230	
	MAXIMUM LOAD OF REG. COUPLING FACE (kips)		192	279	279	314	331	383	436	523	
	MAXIMUM LOAD OF S.C. COUPLING FACE (kips)		96	140	140	157	166	192	218	262	
	PARTING LOAD (kips)										
	REGULAR COUPLING O.D.		472	524	503	536	563	667	728	865	
	SPECIAL CLEARANCE COUPLING O.D.		384	404	384	404	424	505	545	646	
			OUTSIDE DIA.(in)	INSIDE DIA.(in)	WEIGHT (lb)		JOINT EFFICIENCY (%)		30' JOINT MUD DISPLACEMENT (in <sup>2</sup> )		
	REGULAR COUPLING		W	6.075	4.919	20.89		103		2154	
	SPECIAL CLEARANCE COUPLING		Wc	5.890	4.919	15.18		73		2134	
LENGTH OF COUPLING (in)		NL	11.593								
MAKE UP LOSS (in)		ML	4.850								

The above information is for reference only. The information is subject to change or modification without notice. Please contact HSC for the latest information