

TECHNICAL INFORMATION

CASING

SIZE:	6 5/8 "
NOMINAL WEIGHT:	28.00 lb/ft
WALL THICKNESS:	0.417 "
THREADS PER INCH:	5

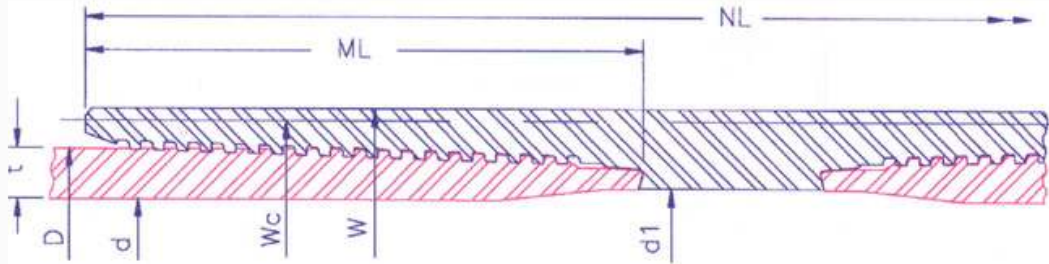

P I P E B O D Y	OUTSIDE DIA.(in)D	6.625	INSIDE DIA.(in) d	5.791	DRIFT DIA. (in)			PLAIN END WT (lb/ft)			27.65
	GRADE		K55	N80	L80	C90	C95	P110	Q125	150	
	COLLAPSE RESISTANCE (psi)		6170	8170	8170	8880	9220	10160	10990	12120	
	INTERNAL YIELD PRESSURE (psi)		6060	8810	8810	9910	10460	12120	13770	16520	
	BODY YIELD STRENGTH (kips)		447	651	651	732	773	895	1017	1220	
	ULTIMATE STRENGTH (kips)		773	813	773	813	854	1017	1098	1301	
	YIELD TORQUE (ft/lb)		62900	91500	91500	102900	108600	125800	142900	171500	

M A K E U P	RECOMMENDED MAKEUP TORQUE USING A THREAD COMPOUND WITH FRICTION CORRECTION FACTOR OF 1.0										
	REGULAR	MINIMUM (ft/lb)	7830	8780	8780	9500	9500	10100	10450	11700	
		OPTIMUM (ft/lb)	8700	9750	9750	10500	10500	11200	11550	13000	
		MAXIMUM (ft/lb)	9570	10720	10720	11500	11500	12300	12650	14300	
	SPECIAL CLEARANCE	MINIMUM (ft/lb)	7830	8780	8780	9500	9500	10100	10450	11700	
		OPTIMUM (ft/lb)	8700	9750	9750	10500	10500	11200	11550	13000	
MAXIMUM (ft/lb)		9570	10720	10720	11500	11500	12300	12650	14300		

C O N N E C T I O N	COLLAPSE RESISTANCE (psi)		6170	8170	8170	8880	9220	10160	10990	12120	
	INTERNAL YIELD PRESSURE (psi)		6060	8810	8810	9910	10460	12120	13770	16520	
	MAXIMUM LOAD OF REG. COUPLING FACE (kips)		392	570	570	642	677	784	891	1070	
	MAXIMUM LOAD OF S.C. COUPLING FACE (kips)		145	211	211	237	250	289	329	395	
	PARTING LOAD (kips)										
	REGULAR COUPLING O.D.		643	721	693	742	780	922	1008	1199	
	SPECIAL CLEARANCE COUPLING O.D.		468	493	468	493	518	616	666	789	
			OUTSIDE DIA.(in)	INSIDE DIA.(in)	WEIGHT (lb)		JOINT EFFICIENCY (%)		30' JOINT MUD DISPLACEMENT (in ³)		
	REGULAR COUPLING		W	7.413	5.955	31.28		119		3024	
	SPECIAL CLEARANCE COUPLING		Wc	7.016	5.955	16.20		64		2971	
LENGTH OF COUPLING (in)		NL	11.829								
MAKE UP LOSS (in)		ML	4.965								

The above information is for reference only. The information is subject to change or modification without notice. Please contact HSC for the latest information