

# TECHNICAL INFORMATION

# CASING

SIZE:	168.28 mm
NOMINAL WEIGHT:	47.62 kg/m
WALL THICKNESS:	12.06 mm
THREADS PER INCH:	5

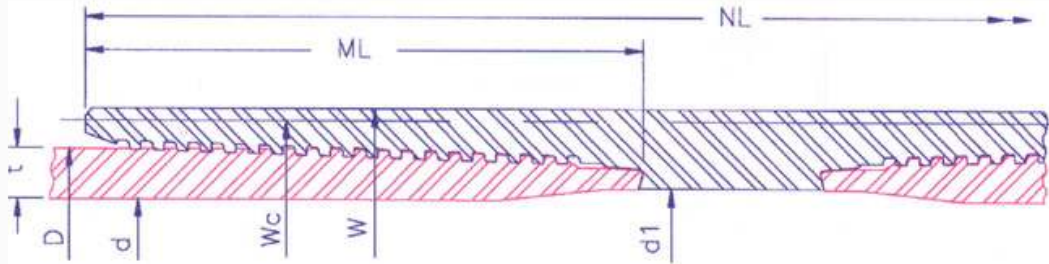

<b>P I P E  B O D Y</b>	<b>OUTSIDE DIA.(mm)D</b>	168.28	<b>INSIDE DIA.(mm) d</b>	144.15	<b>DRIFT DIA. (mm)</b>			140.97	<b>PLAIN END WT (kg/m)</b>		46.43
	<b>GRADE</b>	<b>K55</b>		<b>N80</b>	<b>L80</b>	<b>C90</b>	<b>C95</b>	<b>P110</b>	<b>Q125</b>	<b>150</b>	
	<b>COLLAPSE RESISTANCE (MPa)</b>	50.5		71.2	71.2	78.1	81.5	91.2	100.2	113.8	
	<b>INTERNAL YIELD PRESSURE (MPa)</b>	47.6		69.2	69.2	77.9	82.2	95.2	108.1	129.8	
	<b>BODY YIELD STRENGTH (kN)</b>	2245		3266	3266	3674	3878	4491	5103	6123	
	<b>ULTIMATE STRENGTH (kN)</b>	3878		4082	3878	4082	4286	5103	5511	6532	
	<b>YIELD TORQUE (Nm)</b>	94550		137530	137530	154720	163310	189100	214880	257860	

<b>M A K E  U P</b>	<b>RECOMMENDED MAKEUP TORQUE USING A THREAD COMPOUND WITH FRICTION CORRECTION FACTOR OF 1.0</b>									
	<b>REGULAR</b>	<b>MINIMUM (Nm)</b>	11050	12880	12880	13690	13690	14170	15050	16880
		<b>OPTIMUM (Nm)</b>	12270	14240	14240	15190	15190	15660	16680	18640
		<b>MAXIMUM (Nm)</b>	13490	15590	15590	16680	16680	17150	18300	20410
	<b>SPECIAL CLEARANCE</b>	<b>MINIMUM (Nm)</b>	11050	12880	12880	13690	13690	14170	15050	16880
		<b>OPTIMUM (Nm)</b>	12270	14240	14240	15190	15190	15660	16680	18640
<b>MAXIMUM (Nm)</b>		13490	15590	15590	16680	16680	17150	18300	20410	

<b>C O N N E C T I O N</b>	<b>COLLAPSE RESISTANCE (MPa)</b>		50.5	71.2	71.2	78.1	81.5	91.2	100.2	113.8
	<b>INTERNAL YIELD PRESSURE (MPa)</b>		47.6	69.2	69.2	77.9	82.2	95.2	108.1	129.8
	<b>MAXIMUM LOAD OF REG. COUPLING FACE (kN)</b>		1745	2538	2538	2855	3013	3489	3965	4758
	<b>MAXIMUM LOAD OF S.C. COUPLING FACE (kN)</b>		644	936	936	1054	1112	1288	1463	1756
	<b>PARTING LOAD (kN)</b>									
	<b>REGULAR COUPLING O.D.</b>		3227	3621	3481	3723	3914	4628	5062	6018
	<b>SPECIAL CLEARANCE COUPLING O.D.</b>		2084	2194	2084	2194	2303	2742	2961	3510
			<b>OUTSIDE DIA.(mm)</b>	<b>INSIDE DIA.(mm)</b>	<b>WEIGHT (kg)</b>		<b>JOINT EFFICIENCY (%)</b>		<b>30' JOINT MUD DISPLACEMENT (m³)</b>	
	<b>REGULAR COUPLING</b>		<b>W</b>	188.29	151.26	14.19		106		0.05563
	<b>SPECIAL CLEARANCE COUPLING</b>		<b>Wc</b>	178.21	151.26	7.35		57		0.05476
<b>LENGTH OF COUPLING (mm)</b>		<b>NL</b>	300.46		The above information is for reference only. The information is subject to change or modification without notice. Please contact HSC for the latest information					
<b>MAKE UP LOSS (mm)</b>		<b>ML</b>	126.11							