

TECHNICAL INFORMATION

CASING

SIZE:	193.68 mm
NOMINAL WEIGHT:	39.29 kg/m
WALL THICKNESS:	8.33 mm
THREADS PER INCH:	5

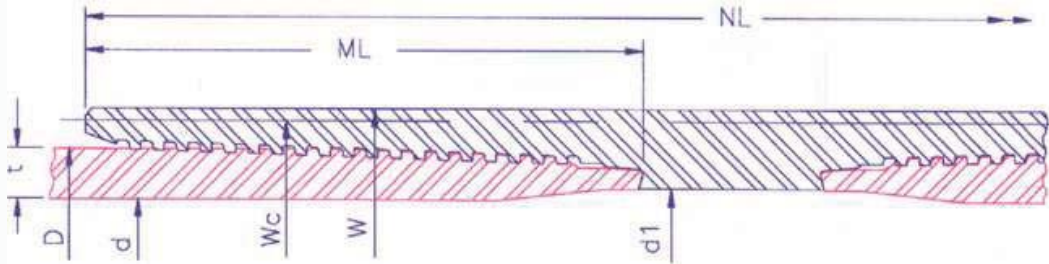

P I P E B O D Y	OUTSIDE DIA.(mm)D	193.68	INSIDE DIA.(mm) d	177.01	DRIFT DIA. (mm)			173.84	PLAIN END WT (kg/m)		38.04
	GRADE		K55	N80	L80	C90	C95	P110	Q125	150	
	COLLAPSE RESISTANCE (MPa)		20.0	23.4	23.4	24.9	25.5	27.0	27.9	28.1	
	INTERNAL YIELD PRESSURE (MPa)		28.5	41.5	41.5	46.7	49.3	57.1	64.9	77.9	
	BODY YIELD STRENGTH (kN)		1840	2676	2676	3010	3177	3679	4181	5017	
	ULTIMATE STRENGTH (kN)		3177	3345	3177	3345	3512	4181	4515	5351	
	YIELD TORQUE (Nm)		94380	137280	137280	154440	163020	188760	214500	257400	

RECOMMENDED MAKEUP TORQUE USING A THREAD COMPOUND WITH FRICTION CORRECTION FACTOR OF 1.0										
M A K E U P	REGULAR	MINIMUM (Nm)	8750	9720	9720	10620	10620	11050	11900	13350
		OPTIMUM (Nm)	9710	10790	10790	11800	11800	12270	13220	14710
		MAXIMUM (Nm)	10670	11860	11860	12980	12980	13490	14530	16070
	SPECIAL CLEARANCE	MINIMUM (Nm)	8750	9720	9720	10620	10620	11050	11900	13350
		OPTIMUM (Nm)	9710	10790	10790	11800	11800	12270	13220	14710
		MAXIMUM (Nm)	10670	11860	11860	12980	12980	13490	14530	16070

C O N N E C T I O N	COLLAPSE RESISTANCE (MPa)		20.0	23.4	23.4	24.9	25.5	27.0	27.9	28.1	
	INTERNAL YIELD PRESSURE (MPa)		28.5	41.5	41.5	46.7	49.3	57.1	64.9	77.9	
	MAXIMUM LOAD OF REG. COUPLING FACE (kN)		2194	3191	3191	3590	3790	4388	4986	5983	
	MAXIMUM LOAD OF S.C. COUPLING FACE (kN)		958	1393	1393	1567	1654	1915	2176	2611	
	PARTING LOAD (kN)										
	REGULAR COUPLING O.D.		2583	2931	2823	3027	3183	3760	4120	4901	
	SPECIAL CLEARANCE COUPLING O.D.		2583	2931	2823	3027	3183	3760	4120	4901	
			OUTSIDE DIA.(mm)	INSIDE DIA.(mm)	WEIGHT (kg)		JOINT EFFICIENCY (%)		30' JOINT MUD DISPLACEMENT (m ³)		
	REGULAR COUPLING		W	216.61	178.84	28.55		172		0.04669	
	SPECIAL CLEARANCE COUPLING		Wc	206.81	178.84	20.30		105		0.04564	
	LENGTH OF COUPLING (mm)		NL	322.45							
MAKE UP LOSS (mm)		ML	137.31								

The above information is for reference only. The information is subject to change or modification without notice. Please contact HSC for the latest information