

# TECHNICAL INFORMATION

# CASING

SIZE:	193.68 mm
NOMINAL WEIGHT:	58.04 kg/m
WALL THICKNESS:	12.70 mm
THREADS PER INCH:	5

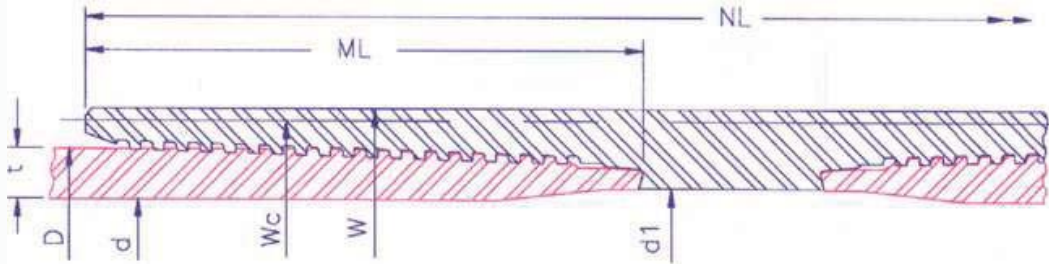

<b>P I P E  B O D Y</b>	OUTSIDE DIA.(mm)D	193.68	INSIDE DIA.(mm) d	168.28	DRIFT DIA. (mm)					165.10	PLAIN END WT (kg/m)	56.62
	GRADE		K55	N80	L80	C90	C95	P110	Q125	150		
	COLLAPSE RESISTANCE (MPa)		45.5	60.8	60.8	66.3	68.9	76.4	83.1	92.7		
	INTERNAL YIELD PRESSURE (MPa)		43.5	63.3	63.3	71.2	75.2	87.0	98.9	118.7		
	BODY YIELD STRENGTH (kN)		2738	3983	3983	4481	4729	5476	6223	7468		
	ULTIMATE STRENGTH (kN)		4729	4978	4729	4978	5227	6223	6721	7965		
	YIELD TORQUE (Nm)		134330	195380	195380	219810	232020	268650	305290	366340		

<b>M A K E  U P</b>	RECOMMENDED MAKEUP TORQUE USING A THREAD COMPOUND WITH FRICTION CORRECTION FACTOR OF 1.0											
	REGULAR	MINIMUM (Nm)	13350	15050	15050	16410	16410	17220	18570	19520		
		OPTIMUM (Nm)	14710	16680	16680	18170	18170	19120	20610	21560		
		MAXIMUM (Nm)	16070	18300	18300	19930	19930	21020	22640	23590		
	SPECIAL CLEARANCE	MINIMUM (Nm)	13350	15050	15050	16410	16410	17220	18570	19520		
		OPTIMUM (Nm)	14710	16680	16680	18170	18170	19120	20610	21560		
MAXIMUM (Nm)		16070	18300	18300	19930	19930	21020	22640	23590			

<b>C O N N E C T I O N</b>	COLLAPSE RESISTANCE (MPa)		45.5	60.8	60.8	66.3	68.9	76.4	83.1	92.7	
	INTERNAL YIELD PRESSURE (MPa)		43.5	63.3	63.3	71.2	75.2	87.0	98.9	118.7	
	MAXIMUM LOAD OF REG. COUPLING FACE (kN)		2194	3191	3191	3590	3790	4388	4986	5983	
	MAXIMUM LOAD OF S.C. COUPLING FACE (kN)		958	1393	1393	1567	1654	1915	2176	2611	
	<b>PARTING LOAD (kN)</b>										
	REGULAR COUPLING O.D.		3845	4363	4202	4506	4738	5597	6133	7295	
	SPECIAL CLEARANCE COUPLING O.D.		3171	3338	3171	3338	3505	4172	4506	5341	
			OUTSIDE DIA.(mm)	INSIDE DIA.(mm)	WEIGHT (kg)		JOINT EFFICIENCY (%)		30' JOINT MUD DISPLACEMENT (m <sup>3</sup> )		
	REGULAR COUPLING		W	216.61	176.25	28.83		116		0.06815	
	SPECIAL CLEARANCE COUPLING		Wc	206.81	176.25	20.59		71		0.06710	
LENGTH OF COUPLING (mm)		NL	322.45								
MAKE UP LOSS (mm)		ML	137.31								

The above information is for reference only. The information is subject to change or modification without notice. Please contact HSC for the latest information