

TECHNICAL INFORMATION

CASING

SIZE:	193.68 mm
NOMINAL WEIGHT:	63.69 kg/m
WALL THICKNESS:	14.27 mm
THREADS PER INCH:	5

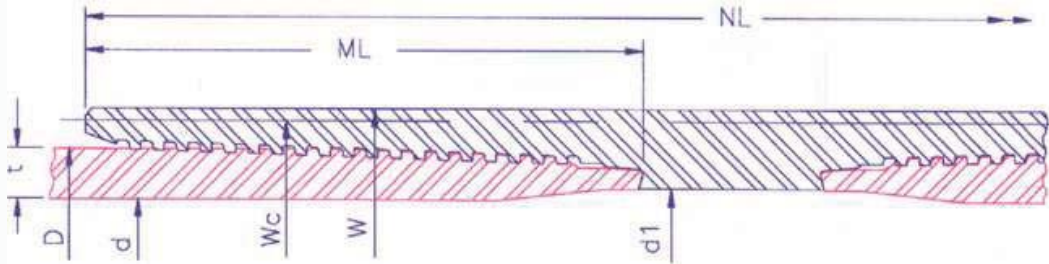

P I P E B O D Y	OUTSIDE DIA.(mm)D	193.68	INSIDE DIA.(mm) d	165.13	DRIFT DIA. (mm)					161.95	PLAIN END WT (kg/m)		63.08
	GRADE			K55	N80	L80	C90	C95	P110	Q125	150		
	COLLAPSE RESISTANCE (MPa)			51.8	74.6	74.6	82.0	85.6	96.0	105.8	120.7		
	INTERNAL YIELD PRESSURE (MPa)			48.9	71.1	71.1	80.0	84.5	97.8	111.2	133.4		
	BODY YIELD STRENGTH (kN)			3051	4438	4438	4992	5270	6102	6934	8321		
	ULTIMATE STRENGTH (kN)			5270	5547	5270	5547	5824	6934	7489	8875		
	YIELD TORQUE (Nm)			147280	214230	214230	241010	254390	294560	334730	401680		

RECOMMENDED MAKEUP TORQUE USING A THREAD COMPOUND WITH FRICTION CORRECTION FACTOR OF 1.0										
M A K E U P	REGULAR	MINIMUM (Nm)	14710	16410	16410	17220	17220	18570	19520	19520
		OPTIMUM (Nm)	16200	18170	18170	19120	19120	20610	21560	21560
		MAXIMUM (Nm)	17690	19930	19930	21020	21020	22640	23590	23590
	SPECIAL CLEARANCE	MINIMUM (Nm)	14710	16410	16410	17220	17220	18570	19520	19520
		OPTIMUM (Nm)	16200	18170	18170	19120	19120	20610	21560	21560
		MAXIMUM (Nm)	17690	19930	19930	21020	21020	22640	23590	23590

C O N N E C T I O N	COLLAPSE RESISTANCE (MPa)			51.8	74.6	74.6	82.0	85.6	96.0	105.8	120.7
	INTERNAL YIELD PRESSURE (MPa)			48.9	71.1	71.1	80.0	84.5	97.8	111.2	133.4
	MAXIMUM LOAD OF REG. COUPLING FACE (kN)			2194	3191	3191	3590	3790	4388	4986	5983
	MAXIMUM LOAD OF S.C. COUPLING FACE (kN)			958	1393	1393	1567	1654	1915	2176	2611
	PARTING LOAD (kN)										
	REGULAR COUPLING O.D.			4284	4862	4682	5021	5280	6236	6834	8129
	SPECIAL CLEARANCE COUPLING O.D.			3171	3338	3171	3338	3505	4172	4506	5341
				OUTSIDE DIA.(mm)	INSIDE DIA.(mm)	WEIGHT (kg)		JOINT EFFICIENCY (%)		30' JOINT MUD DISPLACEMENT (m ³)	
	REGULAR COUPLING			W	216.61	176.25	28.83		104		0.07555
	SPECIAL CLEARANCE COUPLING			Wc	206.81	176.25	20.59		63		0.07450
	LENGTH OF COUPLING (mm)			NL	322.45						
MAKE UP LOSS (mm)			ML	137.31							

The above information is for reference only. The information is subject to change or modification without notice. Please contact HSC for the latest information