

TECHNICAL INFORMATION

CASING

SIZE:	177.80 mm
NOMINAL WEIGHT:	38.69 kg/m
WALL THICKNESS:	9.19 mm
THREADS PER INCH:	5

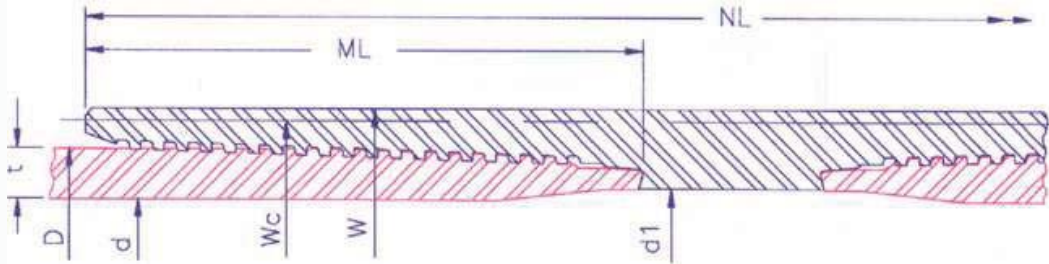

P I P E B O D Y	OUTSIDE DIA.(mm)D	177.80	INSIDE DIA.(mm) d	159.41	DRIFT DIA. (mm)	156.24	PLAIN END WT (kg/m)			38.19
	GRADE	K55		N80	L80	C90	C95	P110	Q125	150
	COLLAPSE RESISTANCE (MPa)	29.8		37.3	37.3	39.6	40.6	43.0	44.5	47.4
	INTERNAL YIELD PRESSURE (MPa)	34.3		49.9	49.9	56.2	59.3	68.6	78.0	93.6
	BODY YIELD STRENGTH (kN)	1847		2686	2686	3022	3190	3694	4198	5037
	ULTIMATE STRENGTH (kN)	3190		3358	3190	3358	3526	4198	4533	5373
	YIELD TORQUE (Nm)	85500		124360	124360	139910	147680	171000	194310	233180

M A K E U P	RECOMMENDED MAKEUP TORQUE USING A THREAD COMPOUND WITH FRICTION CORRECTION FACTOR OF 1.0									
	REGULAR	MINIMUM (Nm)	8830	10130	10130	10620	10620	11470	12410	13350
		OPTIMUM (Nm)	9800	11250	11250	11800	11800	12740	13760	14710
		MAXIMUM (Nm)	10780	12380	12380	12980	12980	14020	15120	16070
	SPECIAL CLEARANCE	MINIMUM (Nm)	8830	10130	10130	10620	10620	11470	12410	13350
		OPTIMUM (Nm)	9800	11250	11250	11800	11800	12740	13760	14710
MAXIMUM (Nm)		10780	12380	12380	12980	12980	14020	15120	16070	

C O N N E C T I O N	COLLAPSE RESISTANCE (MPa)	29.8		37.3	37.3	39.6	40.6	43.0	44.5	47.4	
	INTERNAL YIELD PRESSURE (MPa)	34.3		49.9	49.9	56.2	59.3	68.6	78.0	93.6	
	MAXIMUM LOAD OF REG. COUPLING FACE (kN)	1384		2013	2013	2264	2390	2767	3145	3774	
	MAXIMUM LOAD OF S.C. COUPLING FACE (kN)	541		787	787	885	934	1082	1229	1475	
		PARTING LOAD (kN)									
	REGULAR COUPLING O.D.	2631		2965	2852	3054	3211	3795	4154	4939	
	SPECIAL CLEARANCE COUPLING O.D.	2264		2383	2264	2383	2503	2979	3218	3814	
			OUTSIDE DIA.(mm)	INSIDE DIA.(mm)	WEIGHT (kg)		JOINT EFFICIENCY (%)		30' JOINT MUD DISPLACEMENT (m³)		
	REGULAR COUPLING	W	195.10	162.26	14.91		120		0.04605		
	SPECIAL CLEARANCE COUPLING	Wc	187.71	162.26	9.45		75		0.04536		
LENGTH OF COUPLING (mm)	NL	313.46									
MAKE UP LOSS (mm)	ML	132.79									

The above information is for reference only. The information is subject to change or modification without notice. Please contact HSC for the latest information