

TECHNICAL INFORMATION

CASING

| | |
|-------------------|------------|
| SIZE: | 177.80 mm |
| NOMINAL WEIGHT: | 52.09 kg/m |
| WALL THICKNESS: | 12.65 mm |
| THREADS PER INCH: | 5 |

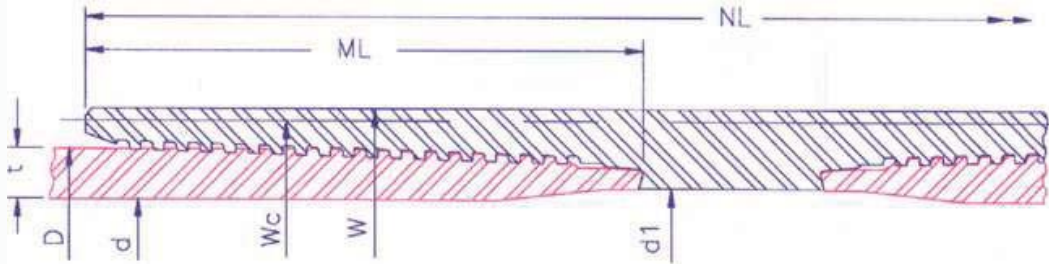

| | | | | | | | | | | |
|---|-------------------------------|--------|-------------------|--------|-----------------|--------|--------|---------------------|--------|--------|
| P I P E B O D Y | OUTSIDE DIA.(mm)D | 177.80 | INSIDE DIA.(mm) d | 152.50 | DRIFT DIA. (mm) | | | PLAIN END WT (kg/m) | | 51.46 |
| | GRADE | | K55 | N80 | L80 | C90 | C95 | P110 | Q125 | 150 |
| | COLLAPSE RESISTANCE (MPa) | | 50.1 | 70.2 | 70.2 | 77.0 | 80.3 | 89.8 | 98.7 | 111.9 |
| | INTERNAL YIELD PRESSURE (MPa) | | 47.2 | 68.7 | 68.7 | 77.3 | 81.5 | 94.4 | 107.3 | 128.8 |
| | BODY YIELD STRENGTH (kN) | | 2489 | 3620 | 3620 | 4072 | 4299 | 4977 | 5656 | 6787 |
| | ULTIMATE STRENGTH (kN) | | 4299 | 4525 | 4299 | 4525 | 4751 | 5656 | 6109 | 7240 |
| | YIELD TORQUE (Nm) | | 110850 | 161240 | 161240 | 181400 | 191480 | 221710 | 251940 | 302330 |

| | | | | | | | | | | |
|---|--|--------------|-------|-------|-------|-------|-------|-------|-------|-------|
| M A K E U P | RECOMMENDED MAKEUP TORQUE USING A THREAD COMPOUND WITH FRICTION CORRECTION FACTOR OF 1.0 | | | | | | | | | |
| | REGULAR | MINIMUM (Nm) | 11470 | 12880 | 12880 | 13690 | 13690 | 14710 | 15520 | 16880 |
| | | OPTIMUM (Nm) | 12740 | 14240 | 14240 | 15190 | 15190 | 16200 | 17150 | 18640 |
| | | MAXIMUM (Nm) | 14020 | 15590 | 15590 | 16680 | 16680 | 17690 | 18780 | 20410 |
| | SPECIAL CLEARANCE | MINIMUM (Nm) | 11470 | 12880 | 12880 | 13690 | 13690 | 14710 | 15520 | 16880 |
| | | OPTIMUM (Nm) | 12740 | 14240 | 14240 | 15190 | 15190 | 16200 | 17150 | 18640 |
| MAXIMUM (Nm) | | 14020 | 15590 | 15590 | 16680 | 16680 | 17690 | 18780 | 20410 | |

| | | | | | | | | | | |
|--|---|----|------------------|-----------------|-------------|-------|----------------------|------|--|---------|
| C O N N E C T I O N | COLLAPSE RESISTANCE (MPa) | | 50.1 | 70.2 | 70.2 | 77.0 | 80.3 | 89.8 | 98.7 | 111.9 |
| | INTERNAL YIELD PRESSURE (MPa) | | 47.2 | 68.7 | 68.7 | 77.3 | 81.5 | 94.4 | 107.3 | 128.8 |
| | MAXIMUM LOAD OF REG. COUPLING FACE (kN) | | 1384 | 2013 | 2013 | 2264 | 2390 | 2767 | 3145 | 3774 |
| | MAXIMUM LOAD OF S.C. COUPLING FACE (kN) | | 541 | 787 | 787 | 885 | 934 | 1082 | 1229 | 1475 |
| | PARTING LOAD (kN) | | | | | | | | | |
| | REGULAR COUPLING O.D. | | 3546 | 3839 | 3647 | 3839 | 4031 | 4799 | 5183 | 6142 |
| | SPECIAL CLEARANCE COUPLING O.D. | | 2264 | 2383 | 2264 | 2383 | 2503 | 2979 | 3218 | 3814 |
| | | | OUTSIDE DIA.(mm) | INSIDE DIA.(mm) | WEIGHT (kg) | | JOINT EFFICIENCY (%) | | 30' JOINT MUD DISPLACEMENT (m ³) | |
| | REGULAR COUPLING | | W | 195.10 | 161.04 | 15.03 | | 89 | | 0.06134 |
| | SPECIAL CLEARANCE COUPLING | | Wc | 187.71 | 161.04 | 9.57 | | 55 | | 0.06064 |
| LENGTH OF COUPLING (mm) | | NL | 313.46 | | | | | | | |
| MAKE UP LOSS (mm) | | ML | 132.79 | | | | | | | |

The above information is for reference only. The information is subject to change or modification without notice. Please contact HSC for the latest information