

# TECHNICAL INFORMATION

# CASING

SIZE:	219.08 mm
NOMINAL WEIGHT:	47.62 kg/m
WALL THICKNESS:	8.94 mm
THREADS PER INCH:	5

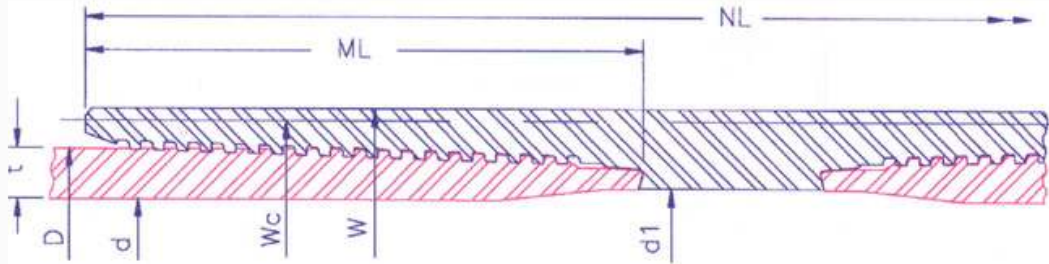

<b>P I P E  B O D Y</b>	OUTSIDE DIA.(mm)D	219.08	INSIDE DIA.(mm) d	201.19	DRIFT DIA. (mm)			198.02	PLAIN END WT (kg/m)		46.28
	GRADE		K55	N80	L80	C90	C95	P110	Q125	150	
	COLLAPSE RESISTANCE (MPa)		17.5	21.0	21.0	22.1	22.6	23.6	23.9	23.9	
	INTERNAL YIELD PRESSURE (MPa)		27.1	39.4	39.4	44.3	46.8	54.2	61.6	73.9	
	BODY YIELD STRENGTH (kN)		2238	3256	3256	3663	3866	4476	5087	6104	
	ULTIMATE STRENGTH (kN)		3866	4070	3866	4070	4273	5087	5494	6511	
	YIELD TORQUE (Nm)		130470	189770	189770	213490	225350	260930	296520	355820	

<b>M A K E  U P</b>	RECOMMENDED MAKEUP TORQUE USING A THREAD COMPOUND WITH FRICTION CORRECTION FACTOR OF 1.0										
	REGULAR	MINIMUM (Nm)	10130	11470	11470	12410	12410	13350	14170	15860	
		OPTIMUM (Nm)	11250	12740	12740	13760	13760	14710	15660	17630	
		MAXIMUM (Nm)	12380	14020	14020	15120	15120	16070	17150	19390	
	SPECIAL CLEARANCE	MINIMUM (Nm)	10130	11470	11470	12410	12410	13350	14170	15860	
		OPTIMUM (Nm)	11250	12740	12740	13760	13760	14710	15660	17630	
MAXIMUM (Nm)		12380	14020	14020	15120	15120	16070	17150	19390		

<b>C O N N E C T I O N</b>	COLLAPSE RESISTANCE (MPa)		17.5	21.0	21.0	22.1	22.6	23.6	23.9	23.9	
	INTERNAL YIELD PRESSURE (MPa)		27.1	39.4	39.4	44.3	46.8	54.2	61.6	73.9	
	MAXIMUM LOAD OF REG. COUPLING FACE (kN)		2905	4225	4225	4754	5018	5810	6602	7923	
	MAXIMUM LOAD OF S.C. COUPLING FACE (kN)		1071	1557	1557	1752	1849	2141	2433	2920	
	PARTING LOAD (kN)										
	REGULAR COUPLING O.D.		3070	3523	3400	3655	3845	4536	4981	5928	
	SPECIAL CLEARANCE COUPLING O.D.		3070	3523	3400	3655	3845	4536	4981	5928	
			OUTSIDE DIA.(mm)	INSIDE DIA.(mm)	WEIGHT (kg)		JOINT EFFICIENCY (%)		30' JOINT MUD DISPLACEMENT (m³)		
	REGULAR COUPLING		W	245.11	204.14	27.65		180		0.05701	
	SPECIAL CLEARANCE COUPLING		Wc	232.21	204.14	15.15		98		0.05541	
LENGTH OF COUPLING (mm)		NL	329.46		The above information is for reference only. The information is subject to change or modification without notice. Please contact HSC for the latest information						
MAKE UP LOSS (mm)		ML	140.84								