

TECHNICAL INFORMATION

CASING

SIZE:	9 5/8 "
NOMINAL WEIGHT:	36.00 lb/ft
WALL THICKNESS:	0.352 "
THREADS PER INCH:	5

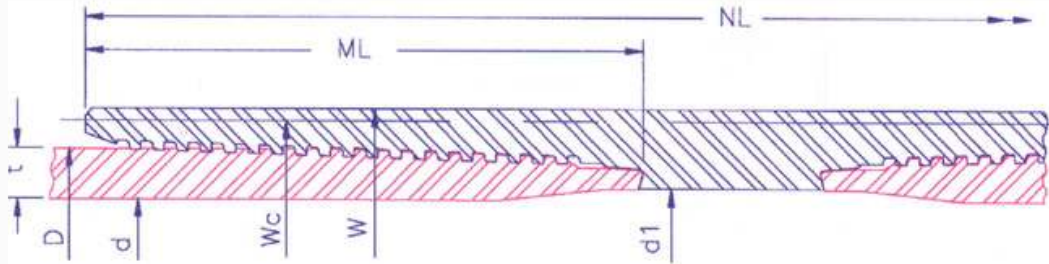

P I P E B O D Y	OUTSIDE DIA.(in)D	9.625	INSIDE DIA.(in) d		8.921	DRIFT DIA. (in)			8.765	PLAIN END WT (lb/ft)		34.86
	GRADE		K55	N80	L80	C90	C95	P110	Q125	150		
	COLLAPSE RESISTANCE (psi)		2020	2370	2370	2440	2460	2470	2470	2470		
	INTERNAL YIELD PRESSURE (psi)		3520	5120	5120	5760	6080	7040	8000	9600		
	BODY YIELD STRENGTH (kips)		564	820	820	923	974	1128	1282	1538		
	ULTIMATE STRENGTH (kips)		974	1025	974	1025	1077	1282	1384	1641		
	YIELD TORQUE (ft/lb)		121400	176600	176600	198600	209700	242800	275900	331100		

RECOMMENDED MAKEUP TORQUE USING A THREAD COMPOUND WITH FRICTION CORRECTION FACTOR OF 1.0										
M A K E U P	REGULAR	MINIMUM (ft/lb)	7830	9150	9150	10100	10100	10850	11700	13050
		OPTIMUM (ft/lb)	8700	10150	10150	11200	11200	11950	13000	14450
		MAXIMUM (ft/lb)	9570	11150	11150	12300	12300	13050	14300	15850
	SPECIAL CLEARANCE	MINIMUM (ft/lb)	7830	9150	9150	10100	10100	10850	11700	13050
		OPTIMUM (ft/lb)	8700	10150	10150	11200	11200	11950	13000	14450
		MAXIMUM (ft/lb)	9570	11150	11150	12300	12300	13050	14300	15850

C O N N E C T I O N	COLLAPSE RESISTANCE (psi)		2020	2370	2370	2440	2460	2470	2470	2470
	INTERNAL YIELD PRESSURE (psi)		3520	5120	5120	5760	6080	7040	8000	9600
	MAXIMUM LOAD OF REG. COUPLING FACE (kips)		723	1051	1051	1183	1249	1446	1643	1971
	MAXIMUM LOAD OF S.C. COUPLING FACE (kips)		267	388	388	436	461	533	606	727
	PARTING LOAD (kips)									
	REGULAR COUPLING O.D.		755	877	848	914	962	1133	1247	1485
	SPECIAL CLEARANCE COUPLING O.D.		755	877	848	914	962	1133	1247	1485
			OUTSIDE DIA.(in)	INSIDE DIA.(in)	WEIGHT (lb)		JOINT EFFICIENCY (%)		30' JOINT MUD DISPLACEMENT (in ²)	
	REGULAR COUPLING		W	10.650	9.037	67.69		178		3897
	SPECIAL CLEARANCE COUPLING		Wc	10.142	9.037	37.20		97		3789
	LENGTH OF COUPLING (in)		NL	12.971						
MAKE UP LOSS (in)		ML	5.545							

The above information is for reference only. The information is subject to change or modification without notice. Please contact HSC for the latest information